

# Express 280

## DC Fast Charging Station

### Service Guide

75-001645-01



# IMPORTANT SAFETY INSTRUCTIONS

## SAVE THESE INSTRUCTIONS

This manual contains important instructions for ChargePoint® products that shall be followed during installation, operation and maintenance of each product.

### WARNING:



1. **Read and follow all warnings and instructions before servicing, installing, or operating the ChargePoint® product.** Install and operate only as instructed. Failure to do so may lead to death, injury, or property damage, and will void the Limited Warranty.
2. **Only use licensed professionals to install your ChargePoint product and adhere to all national and local building codes and standards.** Before installing the ChargePoint product, consult with a licensed contractor, such as a licensed electrician, and use a trained installation expert to ensure compliance with local building and electrical codes and standards, climate conditions, safety standards, and all applicable codes and ordinances. Inspect the product for proper installation before use.
3. **Always ground the ChargePoint product.** A touch current of >3.5 mA AC RMS is possible in case of a fault condition of loss of electrical continuity of the earthing conductor. Failure to ground the product can lead to risk of electric shock. The product must be connected to a grounded, metal, permanent wiring system, or an equipment grounding conductor shall be run with circuit conductors and connected to the equipment grounding terminal or lead on the Electric Vehicle Supply Equipment (EVSE). Connections to the EVSE shall comply with all applicable codes and ordinances.
4. **Install the ChargePoint product using a ChargePoint-approved method.** Failure to install on a surface that can support the full weight of the product can result in death, personal injury, or property damage. Inspect the product for proper installation before use.
5. **The product is not suitable for use in Class 1 hazardous locations, such as near flammable, explosive, or combustible vapors or gases.**
6. **Supervise children near this device.**
7. **Do not put fingers into the electric vehicle connector or connector adapter. Do not touch fingers to charging rails.**
8. **Do not use this product if any cable is frayed, has broken insulation, or shows any other signs of damage.**
9. **Do not use this product if the enclosure, the flexible output cable, the vehicle inlet, the electric vehicle connector, or the electric vehicle connector adapter is broken, cracked, open, or shows any other signs of damage. Do not use this product if internal parts are accessible, including wiring.**
10. **Wire and wire terminal information are provided in the ChargePoint product Site Design Guide and Installation Guide.**
11. **Torques for installation of wire terminals are provided in the ChargePoint product Installation Guide.**



12. **The ChargePoint product maximum operating temperature is 50 °C (122 °F).**
13. **Do not use an electric vehicle connector adapter with any charger or EV that is capable of exceeding the adapter's rated voltage of current capacity. Some EVs and EVSE combinations are capable of multiple voltages or limited durations of current overloading designed for normal EVSE-to-EV connections. Use of an electric vehicle connector adapter in these situations could result in unsafe conditions such as fire, burns, or exposure of high voltage.**



**IMPORTANT:** Under no circumstances will compliance with the information in a ChargePoint guide such as this one relieve the user of the responsibility to comply with all applicable codes and safety standards. This document describes approved procedures. If it is not possible to perform the procedures as indicated, contact ChargePoint. ChargePoint is not responsible for any damages that may result from custom installations or procedures not described in this document or that fail to adhere to ChargePoint recommendations.

## Product Disposal

**Applicable to NA** - Do not dispose of as part of unsorted domestic waste. Inquire with local authorities regarding proper disposal. Product materials are recyclable as marked.



**Applicable to EU** - To comply with Directive 2012/19/EU of the European Parliament and of the Council of 4 July 2012 on waste electrical and electronic equipment (WEEE), devices marked with this symbol may not be disposed of as part of unsorted domestic waste inside the European Union. Enquire with local authorities regarding proper disposal. Product materials are recyclable as marked.



## Document Accuracy

The specifications and other information in this document were verified to be accurate and complete at the time of its publication. However, due to ongoing product improvement, this information is subject to change at any time without prior notice. For the latest information, see our documentation online at [ChargePoint Product Reference Documentation](#).

## Copyright and Trademarks

©2013-2025 ChargePoint, Inc. All rights reserved. This material is protected by the copyright laws of the United States and other countries. It may not be modified, reproduced, or distributed without the prior, express written consent of ChargePoint, Inc. ChargePoint and the ChargePoint logo are trademarks of ChargePoint, Inc., registered in the United States and other countries, and cannot be used without the prior written consent of ChargePoint.

## Symbols

This guide and product use the following symbols:



**DANGER:** Risk of electric shock



**WARNING:** Risk of personal harm or death



**CAUTION:** Risk of equipment or property damage



**IMPORTANT:** Crucial step for installation success



**NOTE:** Helpful information to facilitate installation success



Read the manual for instructions



Ground/protective earth

## Illustrations Used in This Document

The illustrations used in this document are for demonstration purposes only and may not be an exact representation of the product. However, unless otherwise specified, the underlying instructions are accurate for the product.



# Contents

IMPORTANT SAFETY INSTRUCTIONS .....	i
Revision History .....	vi
<b>1 Introduction .....</b>	<b>1</b>
<b>2 Replace the Auxiliary Power Supply .....</b>	<b>5</b>
Bring These Tools and Materials .....	5
Power Off the Station .....	5
Remove the Area Light Bar .....	6
Remove the Top Front Panel .....	7
Remove the Secondary Display Controller and the Auxiliary Power Supply .....	9
Install New Auxiliary Power Supply .....	12
Power On the Station .....	14
<b>3 Replace the Cooling Controller .....</b>	<b>15</b>
Bring These Tools and Materials .....	15
Power Off the Station .....	15
Remove the Upper and Lower Rear Panels .....	15
Remove the Cooling Controller .....	19
Install the New Cooling Controller .....	21
Power On the Station .....	24
<b>4 Replace the Cable Management Kit .....</b>	<b>25</b>
Bring These Tools and Materials .....	25
Power Off the Station .....	26
Remove the Charging Cables .....	26
Remove the Cable Management Kit (CMK) .....	28
Install the New CMK .....	31
Power On the Station .....	31
<b>5 Replace the Fan Tray Assembly .....</b>	<b>32</b>
Bring These Tools and Materials .....	32
Power Off the Station .....	32
Remove the Fan Tray Assembly .....	32
Install the New Fan Tray Assembly .....	35
Power On the Station .....	35

<b>6 Replace a Charging Cable</b>	<b>36</b>
Bring These Tools and Materials	36
Power Off the Station	36
Remove the Area Light Bar	37
Remove the Upper Panels and Top Cap	38
Remove the Charging Cables	43
Remove Data and DC Cables	46
Install the New Charging Cable	48
Power On the Station	53

# Revision History

This page provides a summary of revisions made, listing the month and year of each update along with a brief description of the changes made.

Month & Year	Version Number	Description
November, 2025	v1	Added a new section <u>Replace the Fan Tray Assembly</u> .

# Introduction 1

Follow this guide to service and replace the Express 280 components.

## Before You Begin

### **DANGER:**

**RISK OF SHOCK.** Some stations share DC power ("paired" configuration). Pairing should be marked on the AC disconnect or breaker panel. Before performing this procedure, check for pairing and, if present, disconnect the power to BOTH stations at the service panel.



Whether Standalone or Paired, follow standard practice and local code to de-energize the applicable circuit and lock out/tag out the disconnect before proceeding.

Use a multimeter to test that power is off. Keep power off for this circuit until all cover panels are correctly reinstalled and the work scope is completed. **FAILURE TO FOLLOW THESE INSTRUCTIONS CAN RESULT IN SERIOUS INJURY OR LOSS OF LIFE.**



**WARNING:** Do not install or service the charging station in inclement weather. If you work in snow, rain, or wind, you must use a weather-proof shelter that covers all boxes and components.



**CAUTION:** Keep components in original packaging, free of moisture, and protected from damage until you install or service them at the site. Store all shipments of components in a dry covered location and protect from moisture.



**CAUTION:** Comply with these guidelines to prevent component damage.

- Use tools suitable to torque metric fasteners. All fasteners used are in metric sizes.
- Use the given torque values to tighten the fasteners.



- Ensure that the tools such as torque tool, multimeter, and Ethernet tester are calibrated.

#### **CAUTION:** Warranty Limitation



- If the charging station is not installed, commissioned, or serviced by a ChargePoint Certified Technician using a ChargePoint-approved method, it is excluded from all ChargePoint and other warranties and ChargePoint is not responsible.
- You must be a licensed electrician and complete the training at [chargepoint.com/installers](https://chargepoint.com/installers) to become ChargePoint certified and to access the ChargePoint web or app-based installer tools.



**IMPORTANT:** When you service a charging station, ChargePoint recommends taking a photo before removing each part, so you can refer to the photo when reassembling.



**IMPORTANT:** When removing a part, avoid damage to part by setting it gently on a padded surface.



**WARNING:** Follow Service Guide instructions only. Use only ChargePoint-authorized parts.



**NOTE:** ChargePoint charging stations are available in various product lines and configurations. Images in this document might not match your station exactly; however, the information is applicable unless otherwise noted.

## Additional Documentation

To ensure safety for you and others, do this before you begin:

- Familiarize yourself with the instructions in the Service Guide.
- If you have not installed or serviced the Express 280 recently, orient yourself to the Express 280 by reviewing the [Site Design](#), [Installation](#), and [Datasheet](#), as well as any other materials you find helpful.

Access ChargePoint documents at [ChargePoint Product Reference Documentation](#).

Document	Content	Primary Audiences
Datasheet	Full station specifications	Site designer, installer, and station owner
Site Design Guide	Civil, mechanical, and electrical	Site designer or engineer of

Document	Content	Primary Audiences
	guidelines to scope and construct the site	record
Concrete Mounting Template Guide	Instructions to embed the charging station template in a concrete pad with anchor bolts and conduit placement (these may also be included in the Site Design Guide)	Site construction contractor
Surface Conduit Entry Kit Guide	Instructions for sites where conduit cannot be run underground	Installer
Construction Signoff Form	Checklists used by contractors to ensure the site is correctly completed and ready for product installation	Site construction contractor
Installation Guide	Anchoring, wiring, and powering on	Installer
Operation and Maintenance Guide	Operation and preventive maintenance information	Station owner, facility manager, and technician
Service Guide	Component replacement procedures, including optional components	Service technician
Declaration of Conformity	Statement of conformity with directives	Purchasers and public

## Check and Protect Parts

To ensure your safety, do the following:

- Use only authorized parts and accessories sold and supplied by ChargePoint for the unit and model.
- Keep components in original packaging, free of moisture, and protected from damage until you install or service them at the site.
- Store all shipments of components in a dry covered location and protect from moisture.
- Familiarize yourself with the contents of each shipping box.
- Ensure that you have all the parts for the work you plan to perform.
- Have more than one technician or qualified support person present if components are heavy.
- Keep liquids (and objects containing liquid) away from the unit, never on or inside.



**NOTE:** Do not discard the part you are replacing. Reuse the packaging from the new part to return all removed parts to ChargePoint.

## If Damaged, Do Not Service

Do not perform work or remove any signs or covers from the unit if you find any of the following:

- The charging station housing shows mechanical damage.
- The charging cables or connectors are visibly damaged.
- The station is unstable or moves.

If you find such damage, turn off the station, advise the site manager to keep the unit(s) off, and contact ChargePoint immediately. Find your region's technical support number at [chargepoint.com/support](https://chargepoint.com/support).

## Questions

For assistance, go to [chargepoint.com/support](https://chargepoint.com/support) and find your region's technical support number.

# Replace the Auxiliary Power Supply 2

To replace the auxiliary power supply, complete the following steps.

## Bring These Tools and Materials



Torx screwdriver (T25, T20)



T25 Security screwdriver



Clean rags

## Power Off the Station

Power off at the breaker panel and lock out/tag out before continuing work.

### **DANGER:** RISK OF SHOCK



- Before any procedure, disconnect the power. If station is paired, disconnect the power to both paired charging stations.
- Follow local code and site lockout/tagout procedure to de-energize the station.
- Wait for energy to dissipate (approximately five minutes).
- Keep power off until all covers and panels are reinstalled and the work is complete.

FAILURE TO FOLLOW THESE INSTRUCTIONS CAN RESULT IN SERIOUS INJURY, LOSS OF LIFE, OR PROPERTY DAMAGE.



# Remove the Area Light Bar

To remove the area light bar, complete the following steps:

1. Use a T25 Security screwdriver to loosen the two captive screws on the bottom edge of the area light bar.



**NOTE:** When reinstalling the area light bar, route the cable through the notch in the center of the area light bar. Ensure the cable does not get caught between the area light bar and the secondary display controller. **Torque to 2.8 Nm (25 in-lb).**

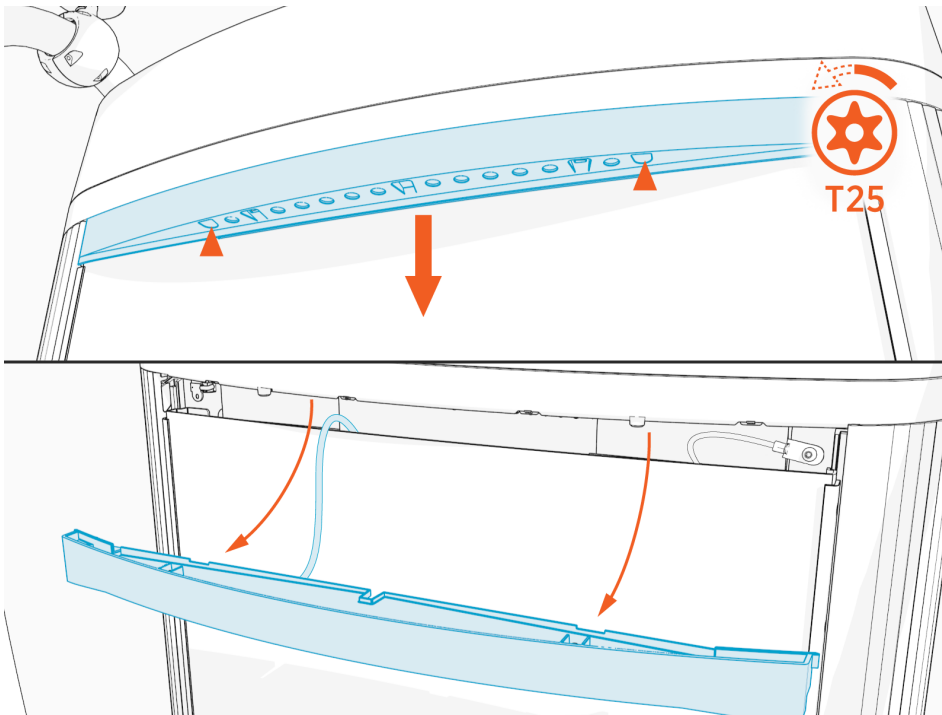

2. While holding the area light bar near the opening at the top of the Express 280, disconnect the 4-pin power cable from the area light bar.

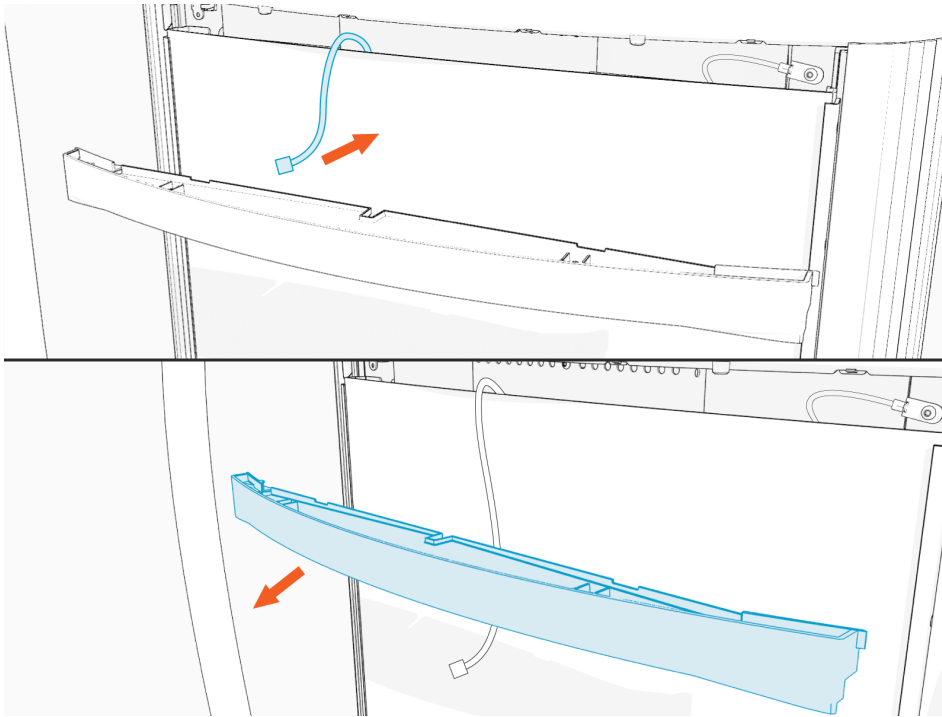

3. Set the area light bar gently on a padded surface.

## Remove the Top Front Panel

To remove the top front panel, complete the following steps:

1. Gently pull the middle section of the trim panel out until the tabs clear the side trim. Remove the trim panel.

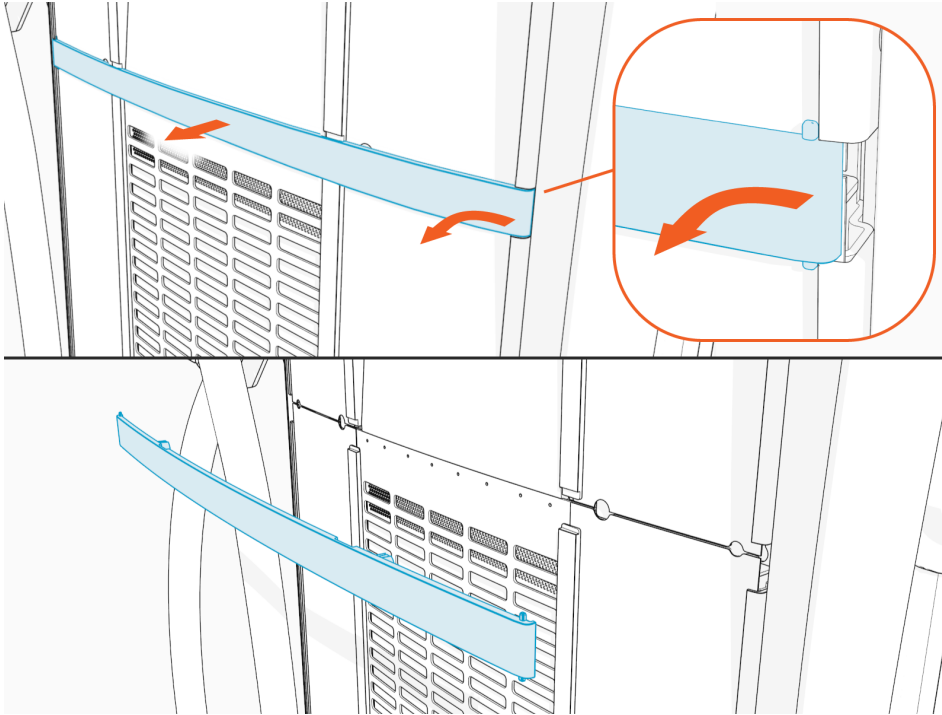

2. Use a T25 Torx screwdriver to remove the screw securing the ground cable to the station frame.

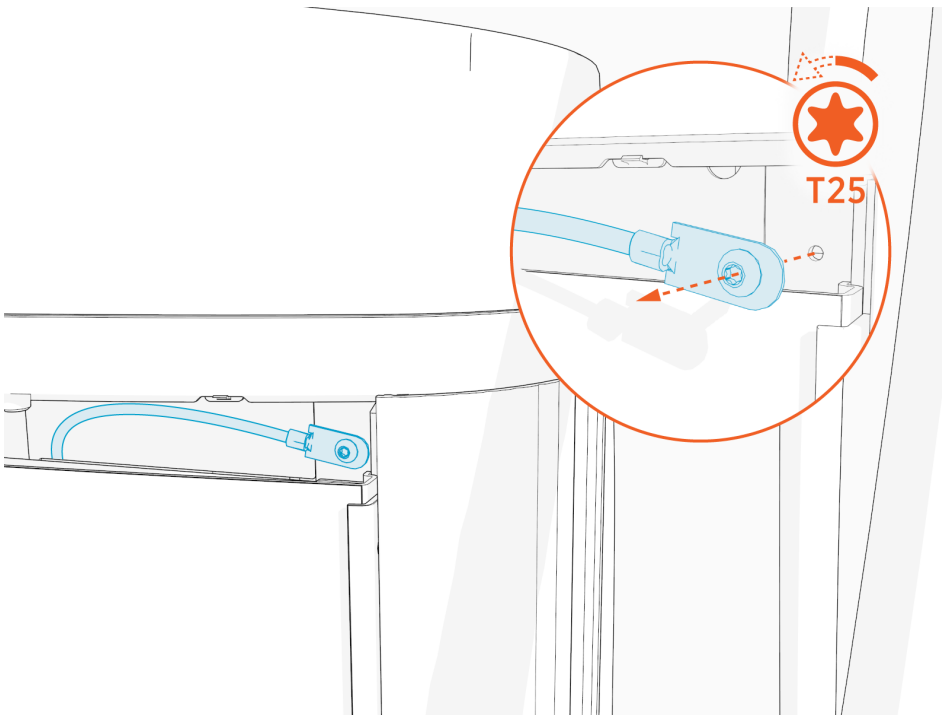

3. Use both hands to carefully pull the panel away from the station body. Lift upward to remove it.

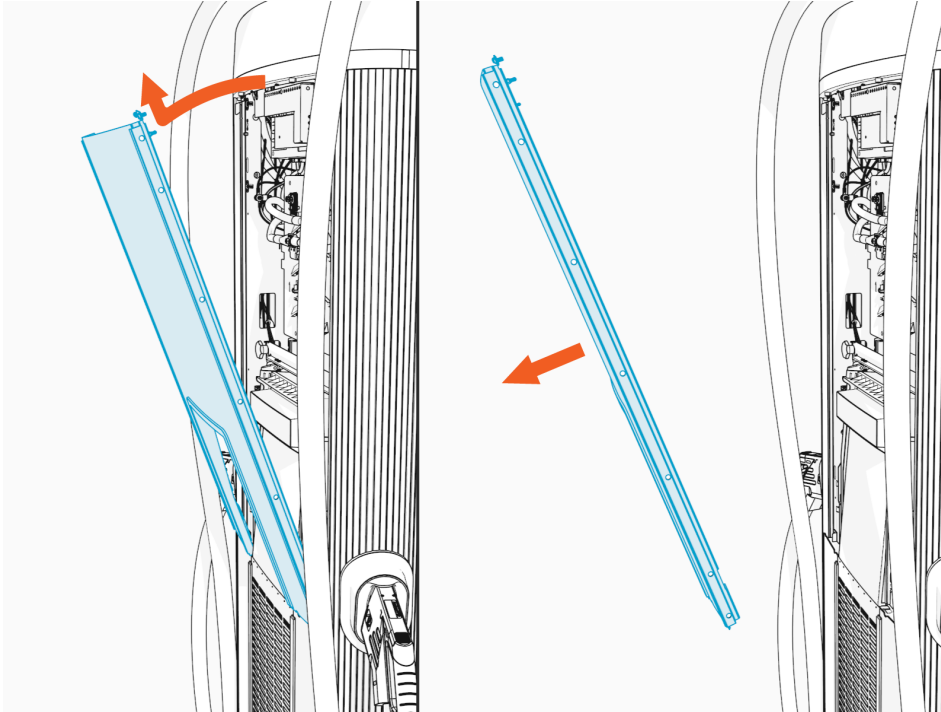

4. Place a protective cover, such as a lint-free cloth, over the touchscreen to prevent damage during service.

## Remove the Secondary Display Controller and the Auxiliary Power Supply

To remove the secondary display controller and the auxiliary power supply, complete the following steps:

1. Disconnect the cables from the secondary display controller.

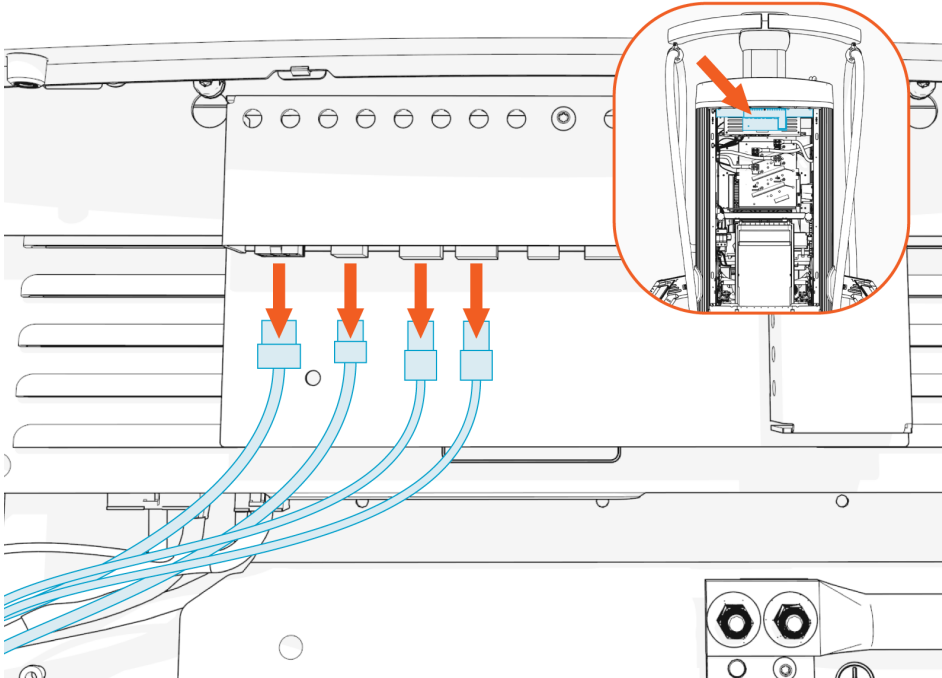

2. Use a T25 Torx screwdriver to loosen the four screws that secure the secondary display controller.

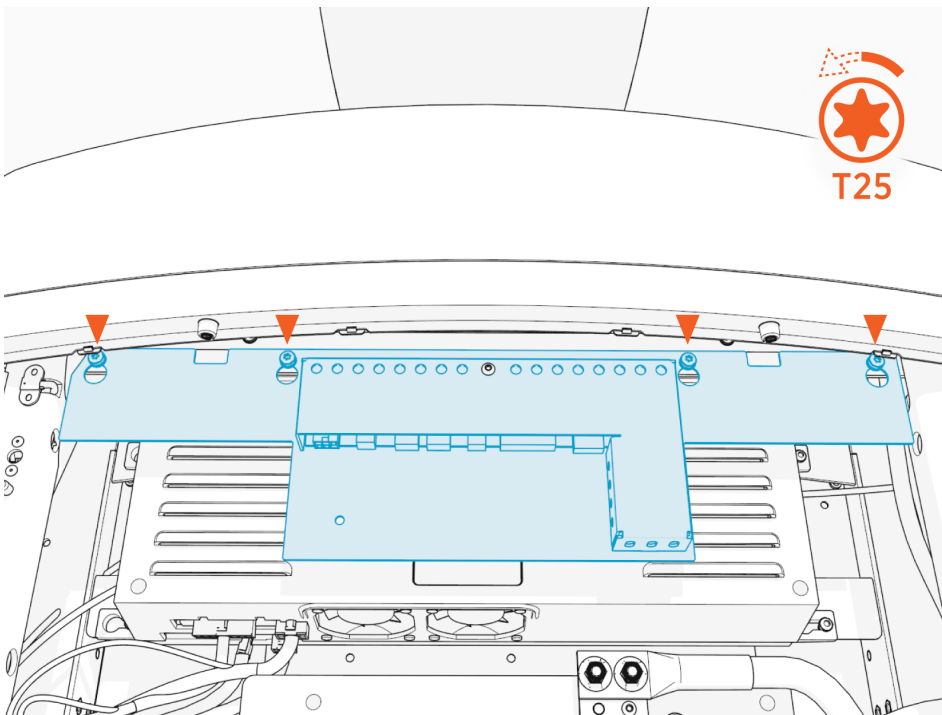

3. Slide the secondary display controller up and off the keyholes to remove it.

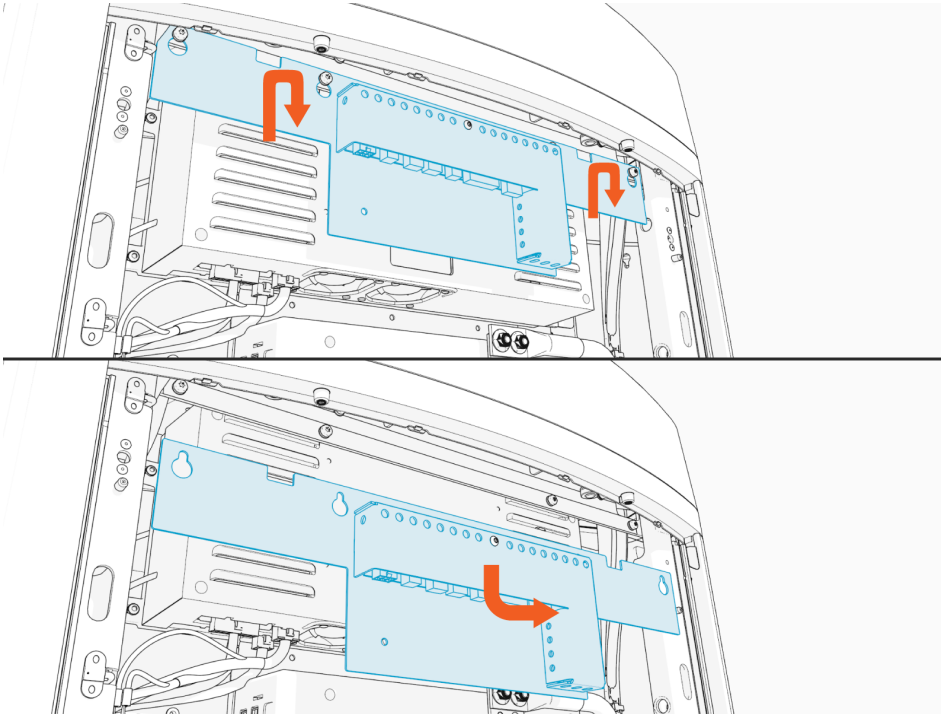

4. Set the controller aside gently.
5. Disconnect the cables from the auxiliary power supply:

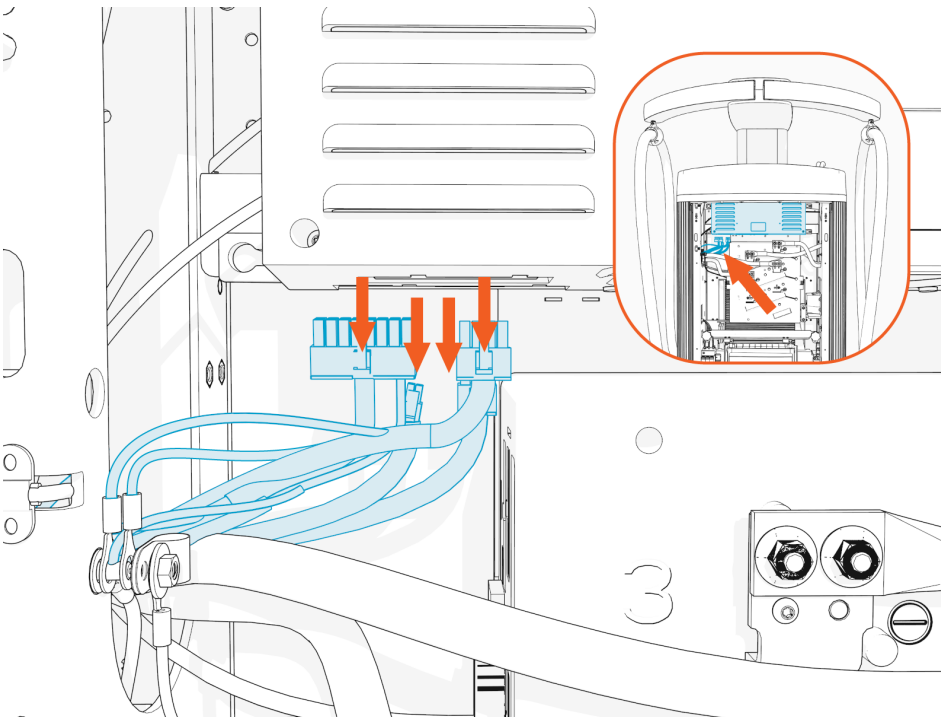

6. Use a T20 Torx screwdriver to loosen the four screws securing the auxiliary power supply.

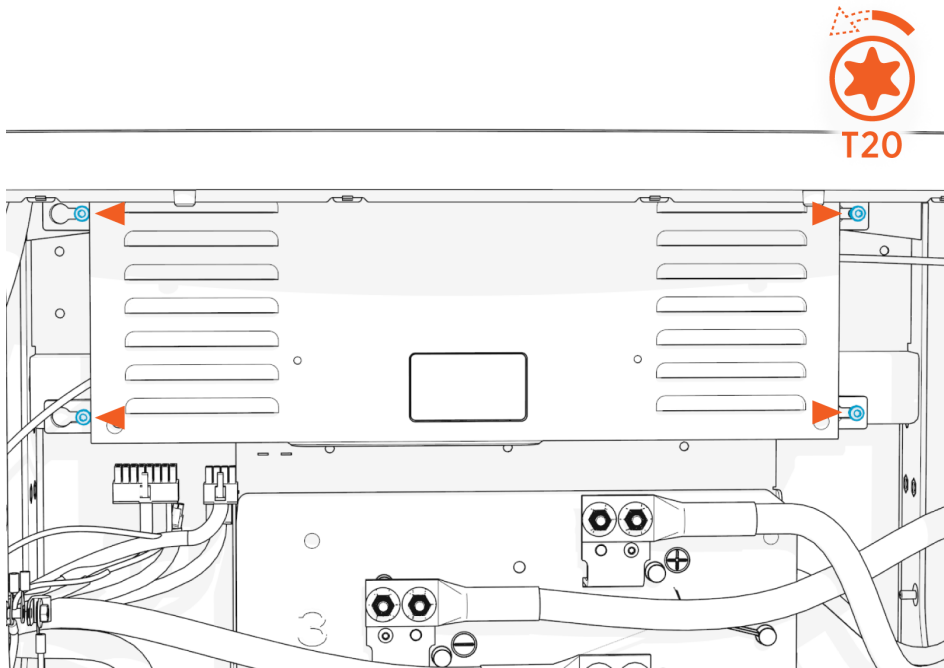

7. Slide the auxiliary power supply to the right and off the keyholes to remove it.

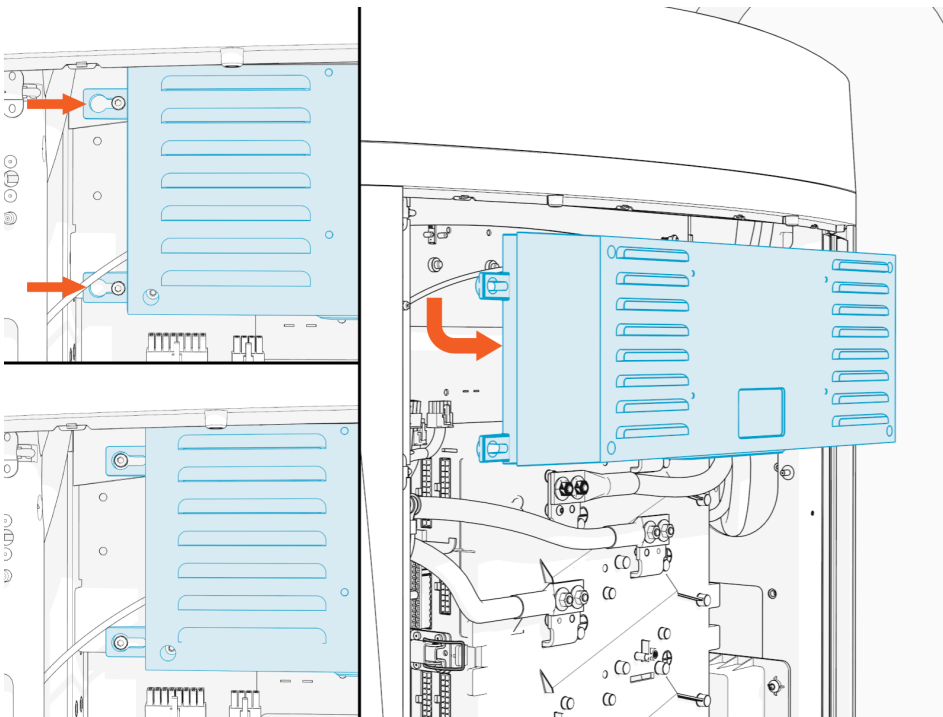

## Install New Auxiliary Power Supply

To install the new auxiliary power supply, complete the following steps:

1. Align the keyholes on the new auxiliary power supply with the screws on the station and slide it into position.

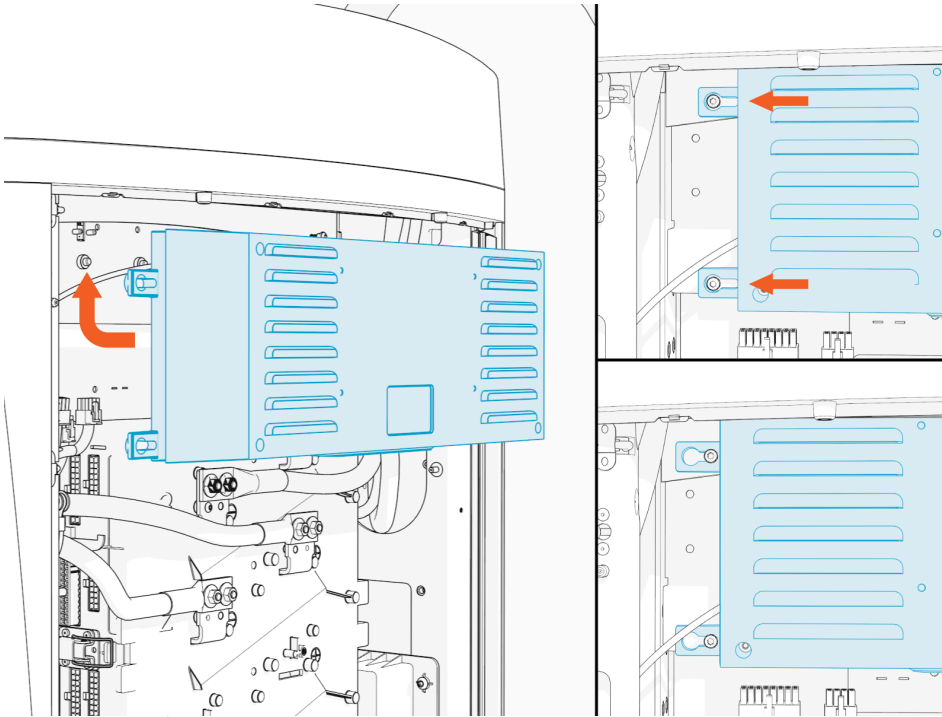

**IMPORTANT:**

Ensure the nylon shoulder washer is in between the screw head and the auxiliary power supply.

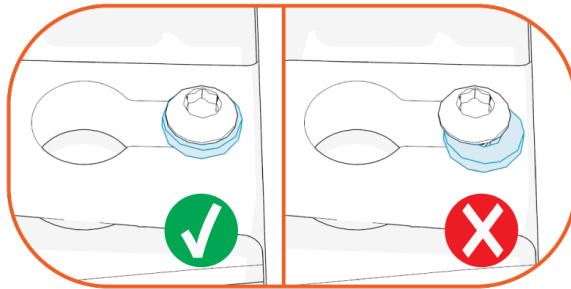

2. Connect the six cables from the power supply to the station.



3. Use a T20 Torx screwdriver and four screws to secure the power supply. **Torque to 2.3 Nm (20 in-lb).**

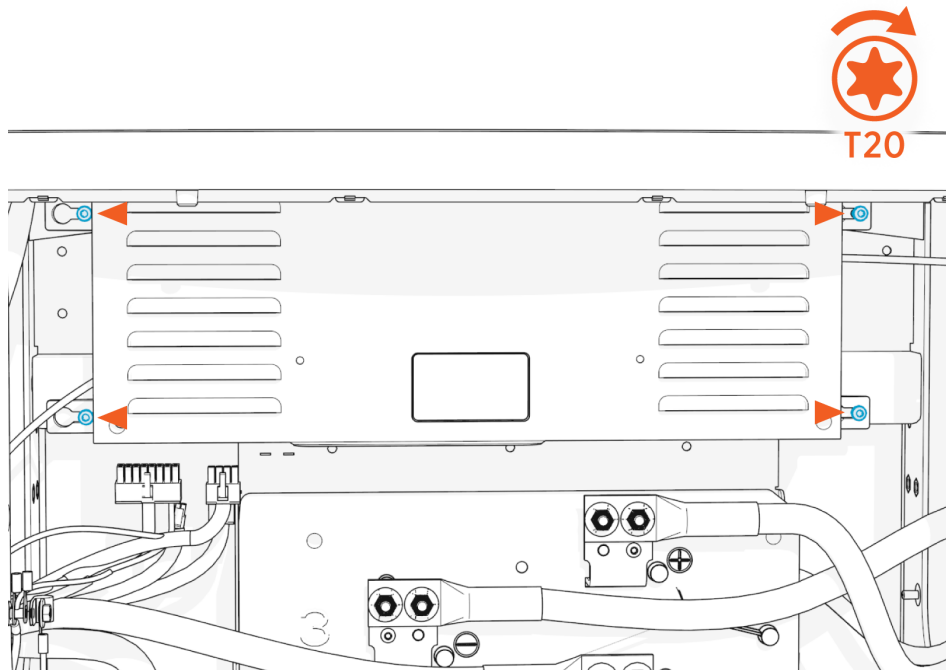

**REVERSE THE ABOVE STEPS TO REPLACE THE SECONDARY DISPLAY CONTROLLER, TOP FRONT PANEL, TRIM TAB, AND AREA LIGHT BAR.**



**IMPORTANT:** When reinstalling, ensure the cables at the top of the panel are not captured by the front upper panel and are easily accessible for reinstalling the area light bar.

## Power On the Station



**DANGER:** Ensure all panels are installed before powering station on.

Once all parts are installed, power on the Express 280. The Express 280 runs a self test to verify that it can operate properly.



**DANGER:** RISK OF SHOCK. If a fault exists, turn the power off at the service panel to BOTH product paired charging stations during work and keep it off until all panels are reinstalled. Internal components can present a shock hazard. FAILURE TO FOLLOW THESE INSTRUCTIONS CAN RESULT IN SERIOUS INJURY OR LOSS OF LIFE.

# Replace the Cooling Controller 3

To replace the cooling controller, complete the following steps.

## Bring These Tools and Materials



T25 Security screwdriver



Torx screwdriver (T25, T20)



Stepladder



Headlamp

## Power Off the Station

Power off at the breaker panel and lock out/tag out before continuing work.

### **DANGER:** RISK OF SHOCK



- Before any procedure, disconnect the power. If station is paired, disconnect the power to both paired charging stations.
- Follow local code and site lockout/tagout procedure to de-energize the station.
- Wait for energy to dissipate (approximately five minutes).
- Keep power off until all covers and panels are reinstalled and the work is complete.

FAILURE TO FOLLOW THESE INSTRUCTIONS CAN RESULT IN SERIOUS INJURY, LOSS OF LIFE, OR PROPERTY DAMAGE.

## Remove the Upper and Lower Rear Panels

To remove the upper and lower rear panels, complete the following steps:

1. Use a T25 security screwdriver to loosen the two screws that secure the top of the upper rear panel to the enclosure frame.



**NOTE:** When replacing this panel, **torque to 4.5 Nm (40 in-lb).**

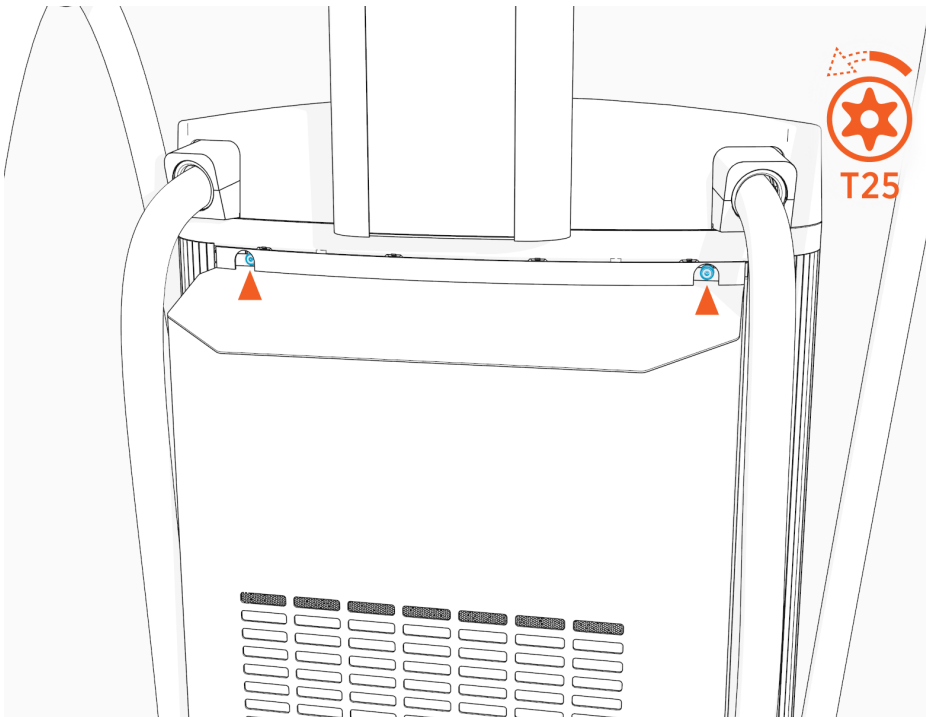

- 
2. Use two hands to pull the upper rear panel away from the station and lift up and off the keyholes to remove it.

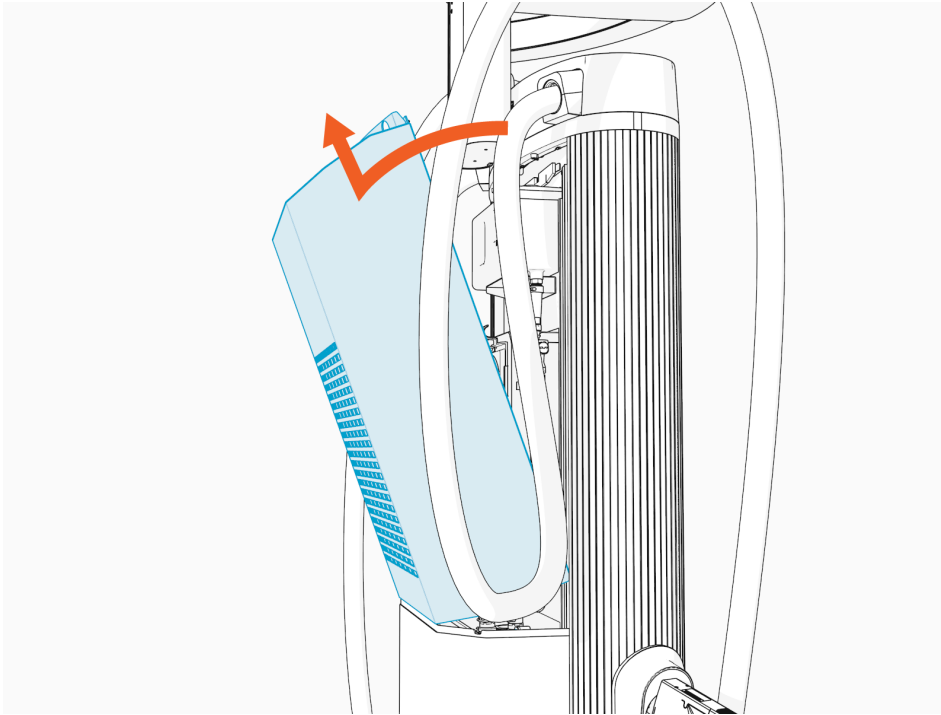

3. Use a T25 Torx screwdriver to loosen the two screws securing the top of the lower rear panel to the enclosure frame.



**NOTE:** When replacing this panel, torque to 4.5 Nm (40 in-lb).

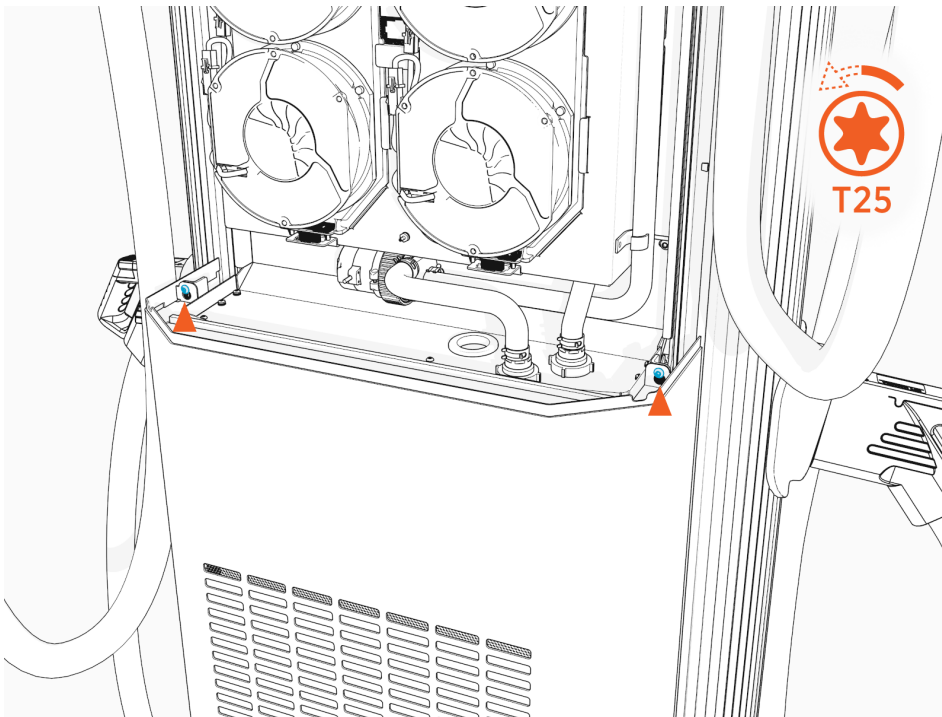

4. Use both hands to pull the upper rear panel away from the station and lift up to remove it.

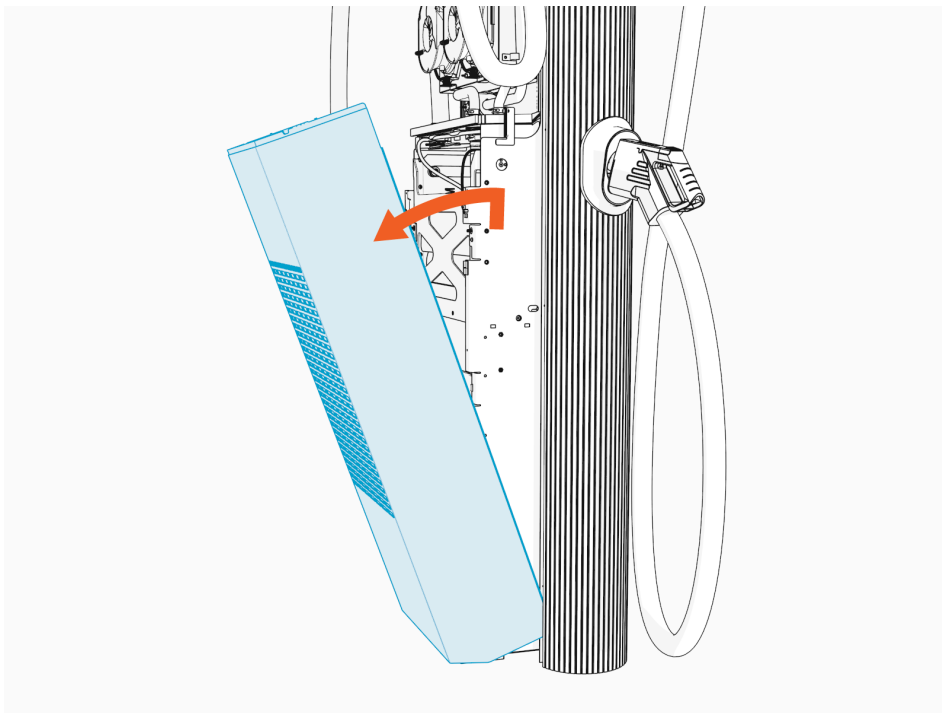

## Remove the Cooling Controller

To remove the cooling controller, complete the following steps:

1. Identify the cooling controller, located near the center of the station.

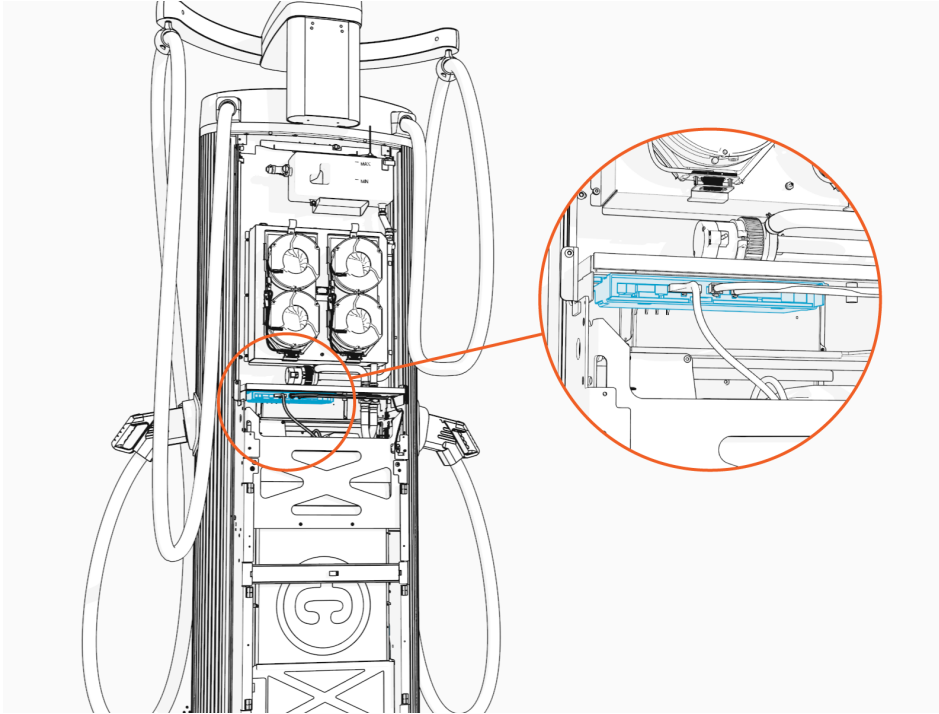

2. Remove each cable attached to the front of the cooling controller by pressing in on its tab and pulling out by hand.

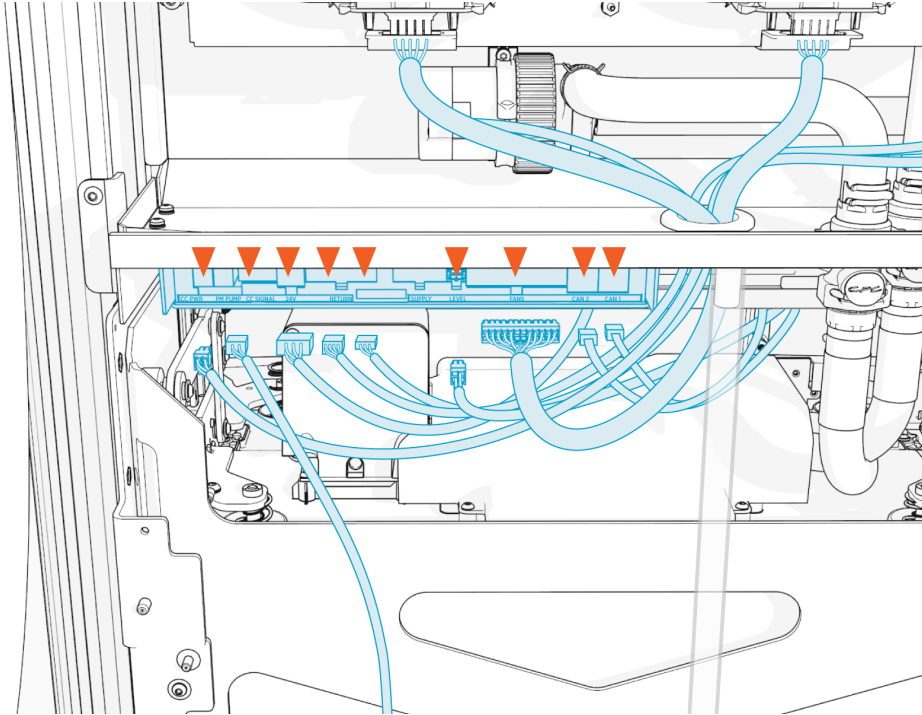

3. Use a T20 Torx screwdriver to remove the two screws attaching the controller to the frame shelf. Save the screws for reuse.

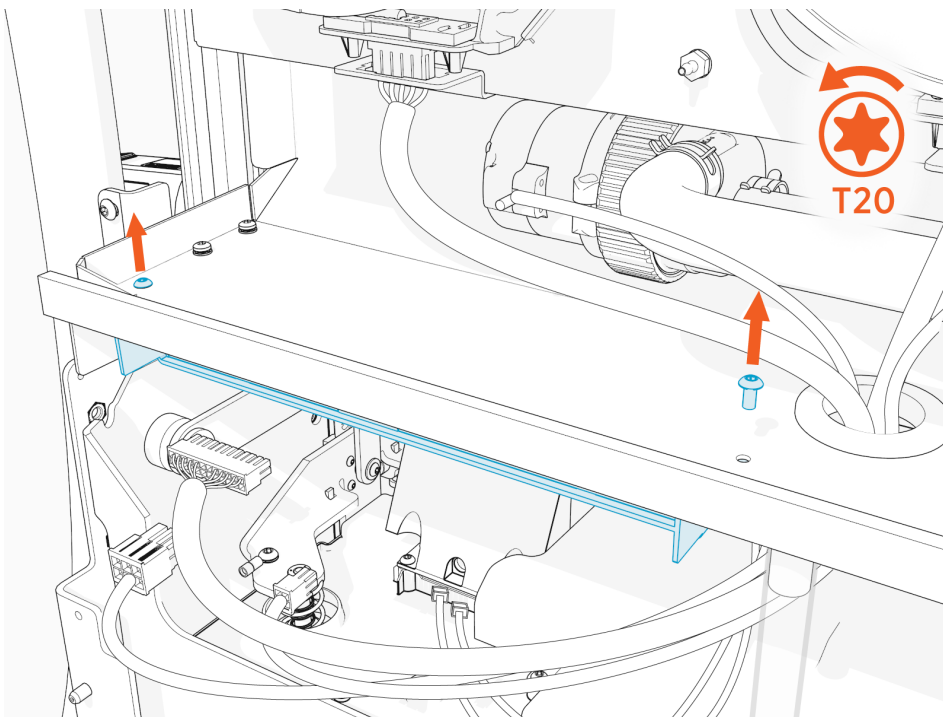

4. Remove the cooling controller.

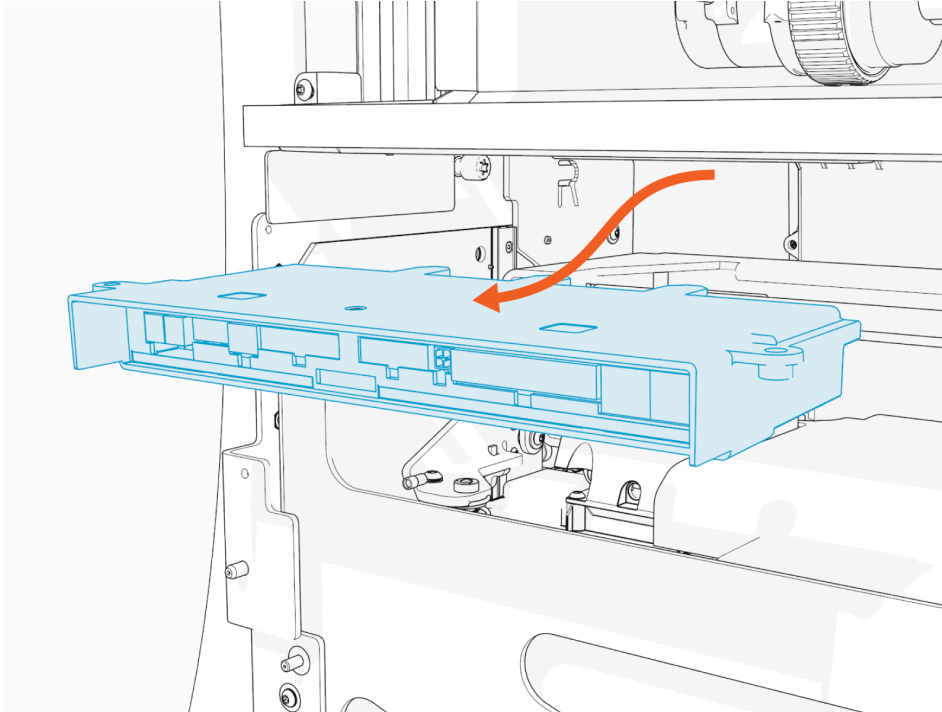

## **Install the New Cooling Controller**

To install the new cooling controller, complete the following steps:



1. Align the back edge of the new cooling controller with the bracket in the station.

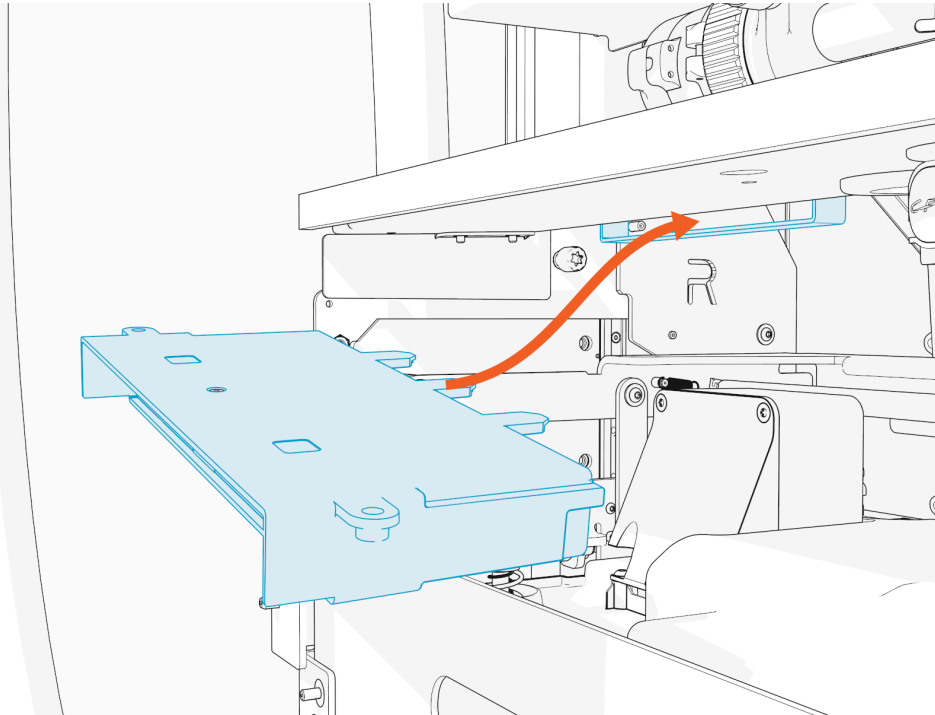

2. Use a T20 Torx screwdriver to replace the two screws attaching the controller to the frame. Fasten hand-tight.

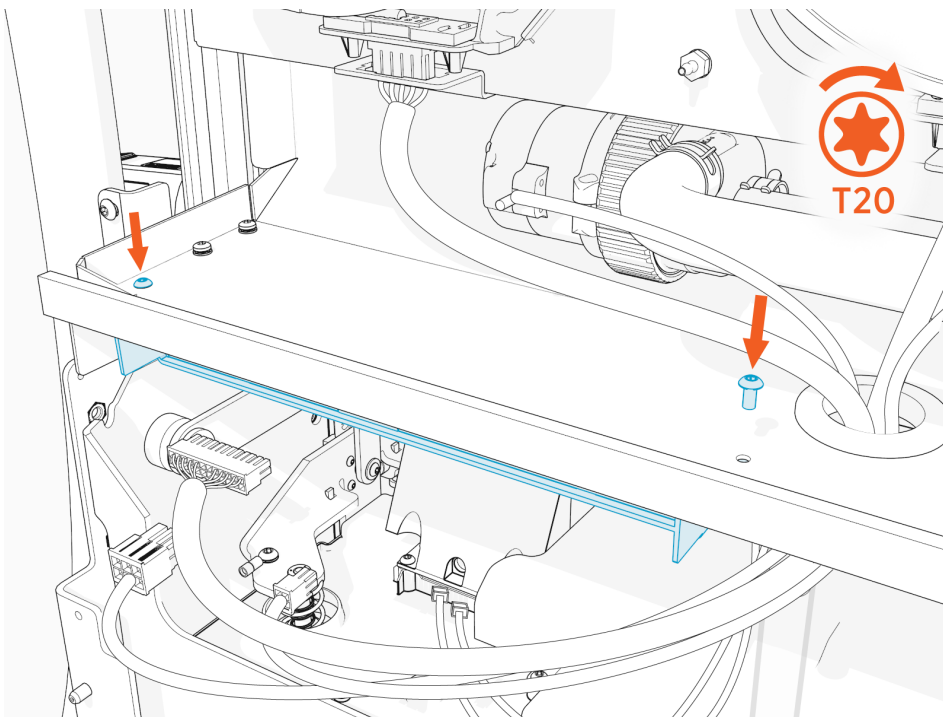

3. Reattach all cables to the front of the cooling controller.

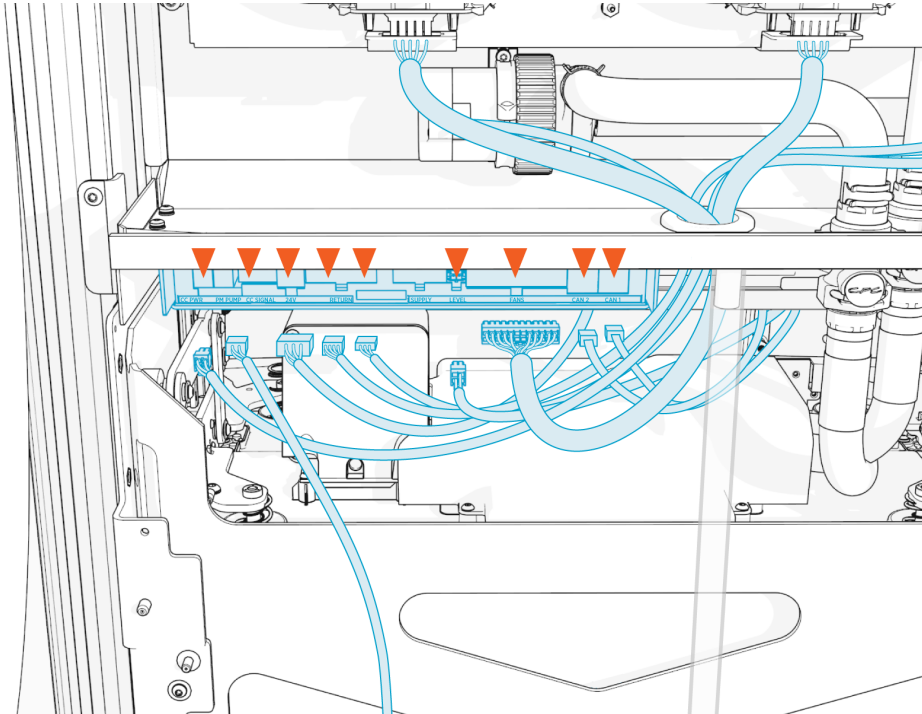

4. Route the slack of all cooling controller cables gently back through the grommet in the frame shelf. Ensure the cables are clear of the Power Modules.

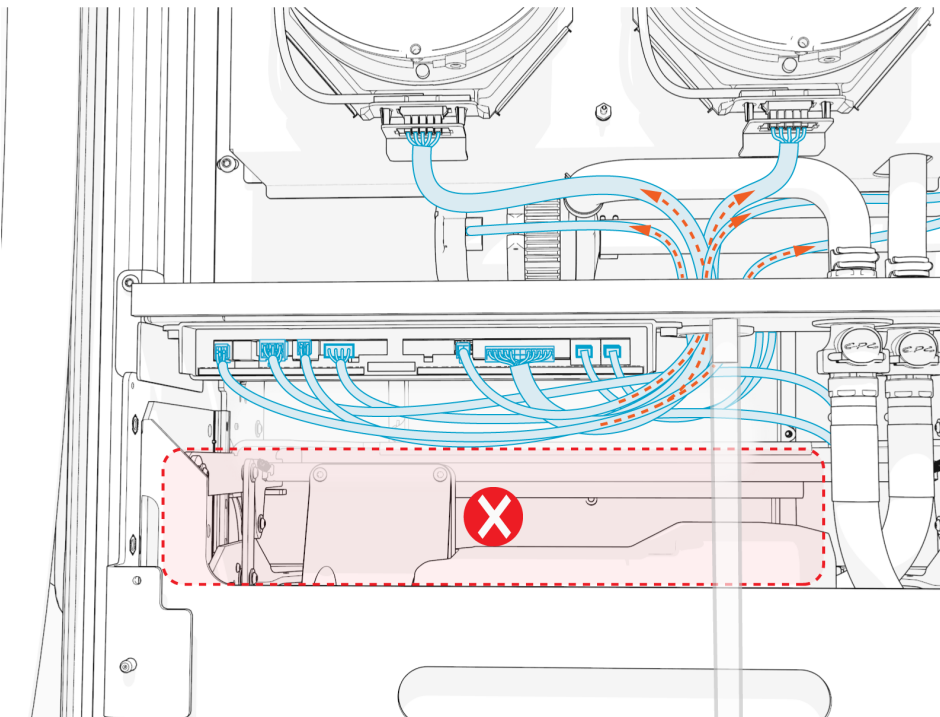

**REVERSE THE ABOVE STEPS TO REPLACE THE REAR PANELS.**

## Power On the Station



**DANGER:** Ensure all panels are installed before powering station on.

Once all parts are installed, power on the Express 280. The Express 280 runs a self test to verify that it can operate properly.



**DANGER:** RISK OF SHOCK. If a fault exists, turn the power off at the service panel to BOTH product paired charging stations during work and keep it off until all panels are reinstalled. Internal components can present a shock hazard. FAILURE TO FOLLOW THESE INSTRUCTIONS CAN RESULT IN SERIOUS INJURY OR LOSS OF LIFE.

# Replace the Cable Management Kit 4

The Cable Management Kit (CMK) includes the following parts:

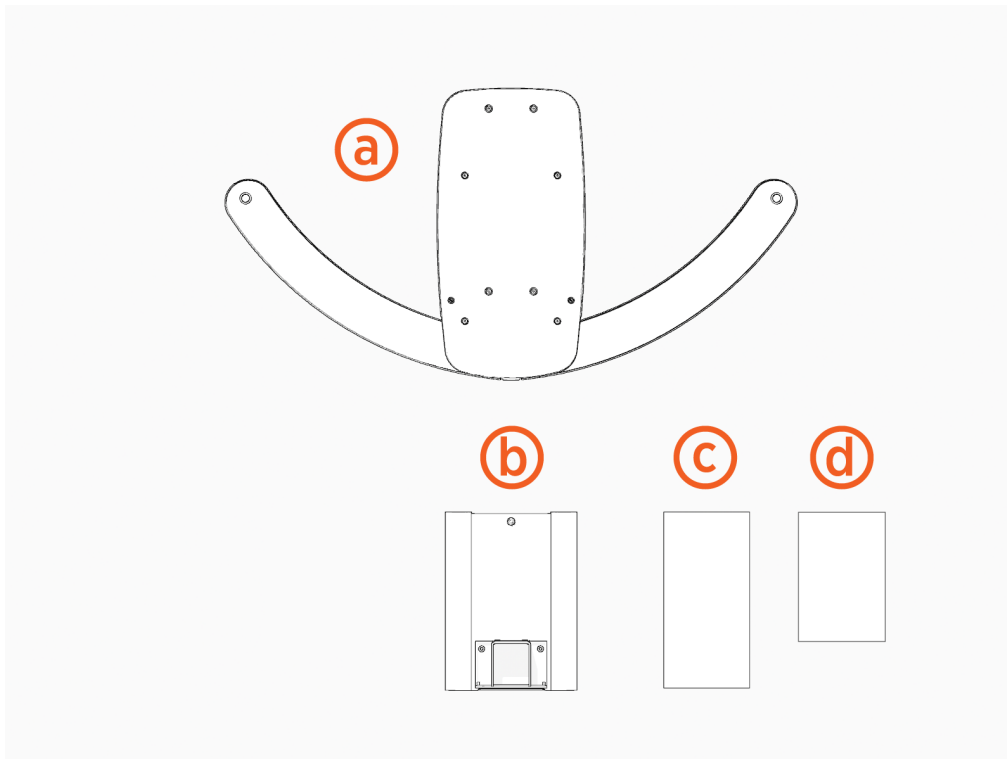

- (a) Swingarm
- (b) Mast
- (c) Front cover
- (d) Rear cover

To replace the cable management kit, complete the following steps.

## Bring These Tools and Materials



T20 Torx screwdriver (T20, T30)



Headlamp

# Power Off the Station

Power off at the breaker panel and lock out/tag out before continuing work.

## **DANGER:** RISK OF SHOCK



- Before any procedure, disconnect the power. If station is paired, disconnect the power to both paired charging stations.
- Follow local code and site lockout/tagout procedure to de-energize the station.
- Wait for energy to dissipate (approximately five minutes).
- Keep power off until all covers and panels are reinstalled and the work is complete.

FAILURE TO FOLLOW THESE INSTRUCTIONS CAN RESULT IN SERIOUS INJURY, LOSS OF LIFE, OR PROPERTY DAMAGE.

## Remove the Charging Cables

To remove the charging cables, complete the following steps:

1. Remove the charging cables and set them down gently on a padded surface.

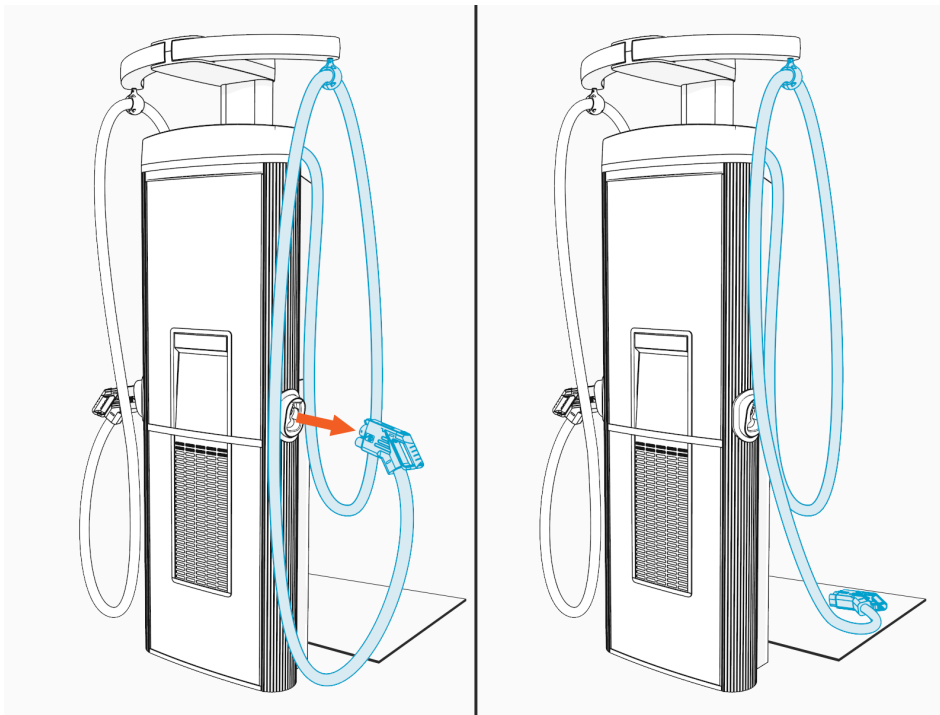

2. Use a T20 Torx screwdriver to loosen the set screw on the tether ball. Use a flat blade screwdriver to depress the spring while pushing the tether ball up to remove the tether ball.



**NOTE:** When replacing the tether ball and cable, align the spring in the ball clamp with the flat notch on the anchor pin. When aligned, push the ball clamp onto the anchor pin. **Torque the set screw to 2.8 Nm (25 in-lb).**

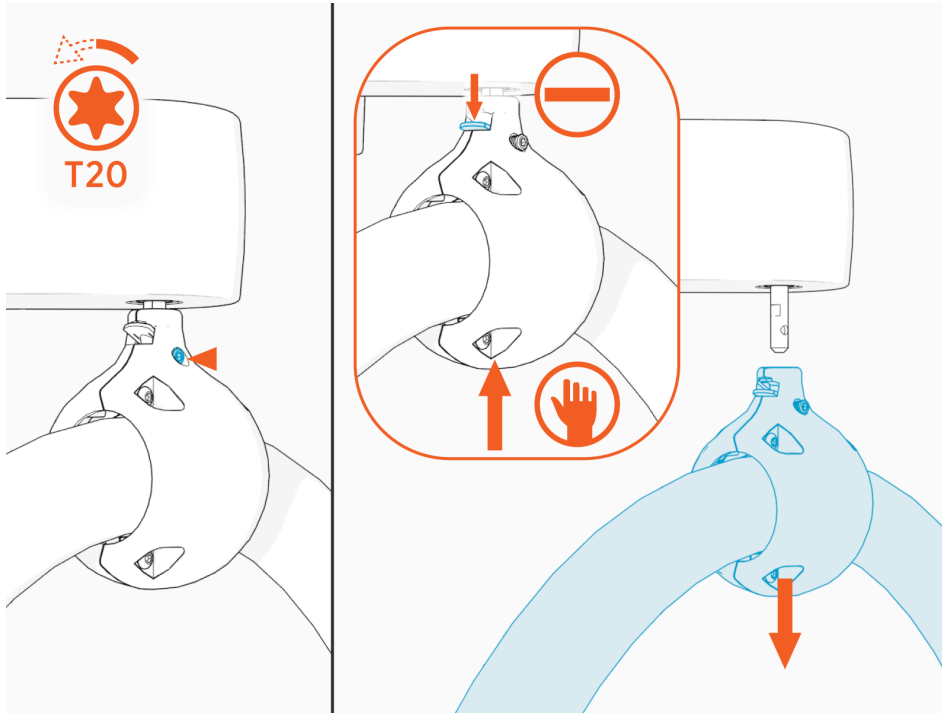

3. Set the charging cable aside gently.

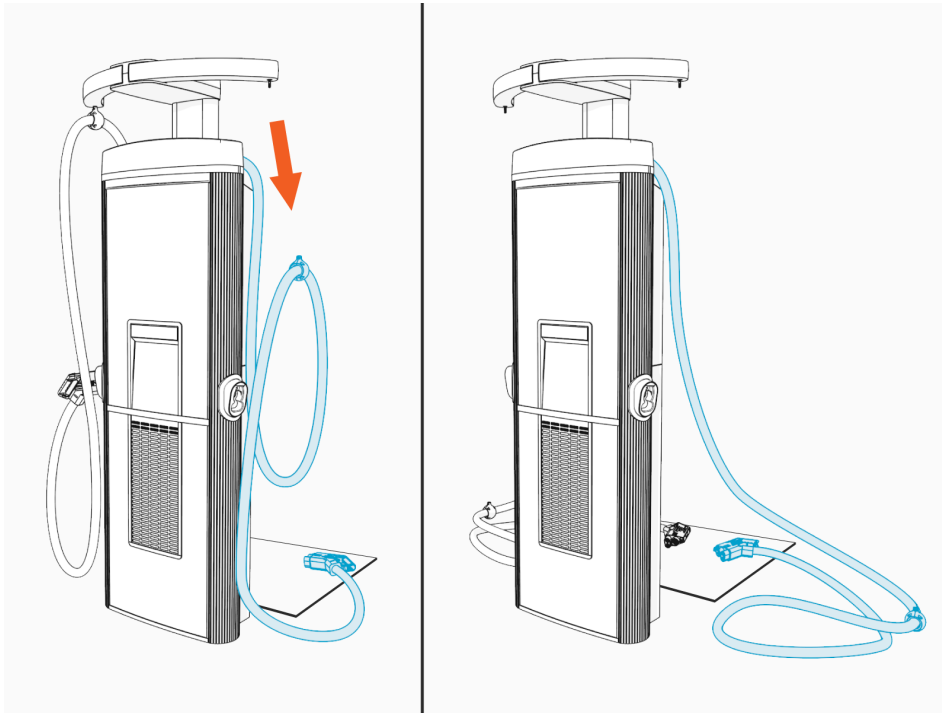

## Remove the Cable Management Kit (CMK)

To remove the Cable Management Kit (CMK), complete the following steps:

1. Remove the front cover from the CMK mast and set it aside.

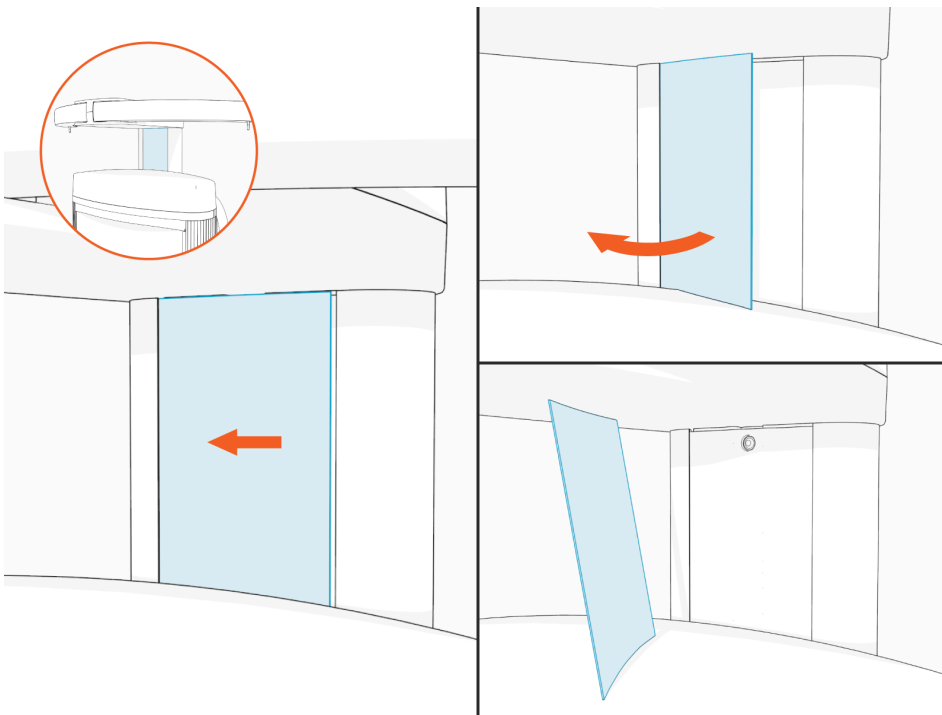

2. Remove the rear cover from the CMK mast and set it aside.

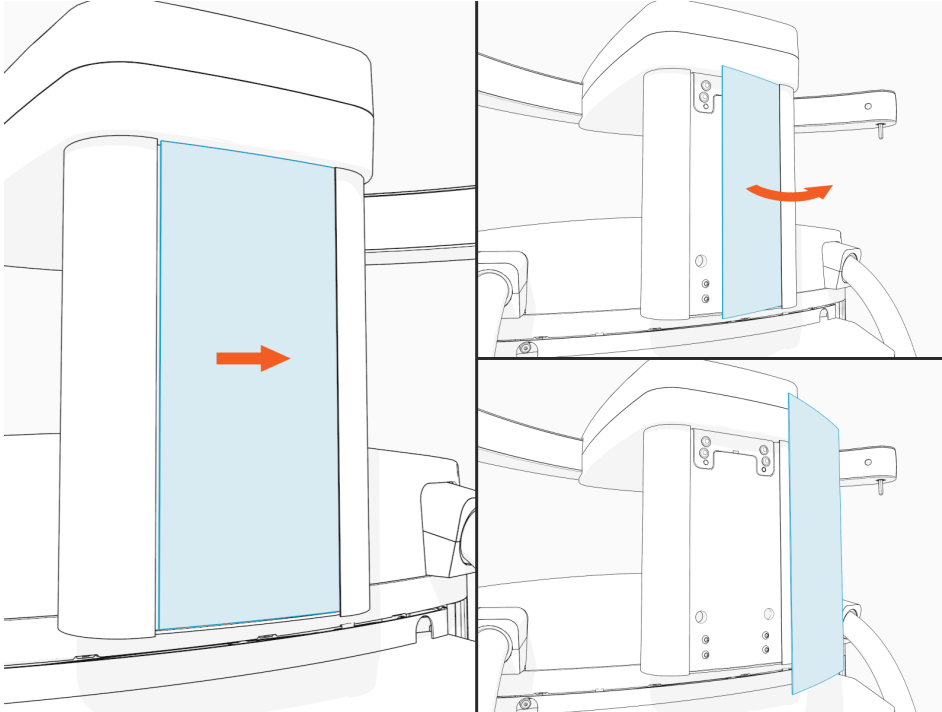



- Using a T30 Torx screwdriver, remove the four screws securing the swingarm assembly from the back of the mast. Loosen the screw in the front and remove the swingarm assembly.



**NOTE:** When installing the new swingarm assembly, **torque to 5.6 Nm (50 in-lb).**

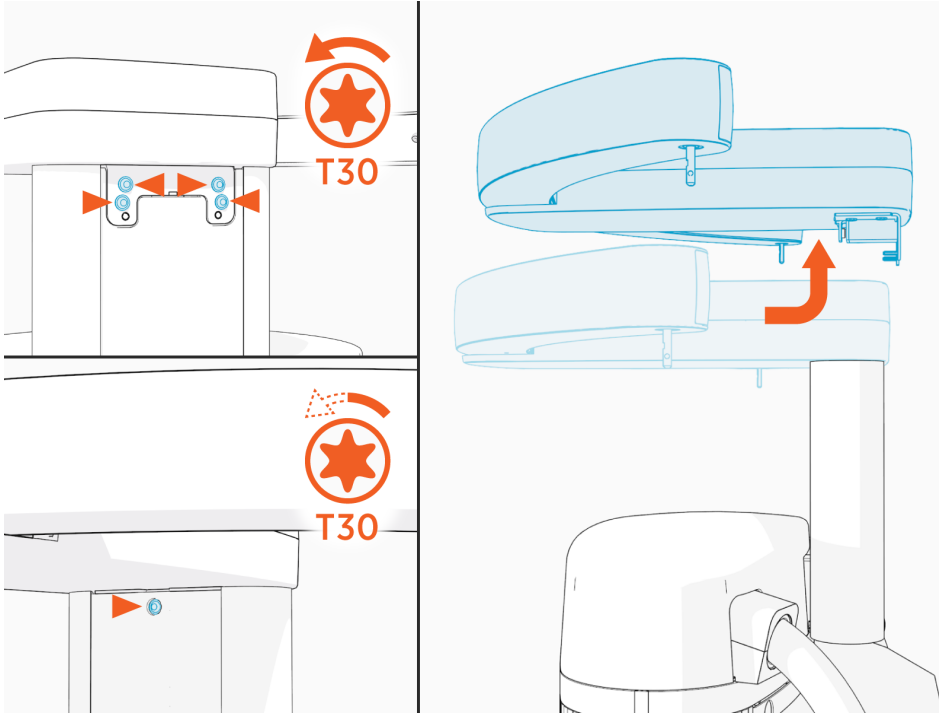

- Using a T30 Torx screwdriver, remove four screws securing the CMK mast to the Express 280. Loosen two upper screws and lift the mast so it clears the keyholes before removing it.



**NOTE:** When installing the new mast, **torque the screws to 4.65 Nm (50 in lbs)**.

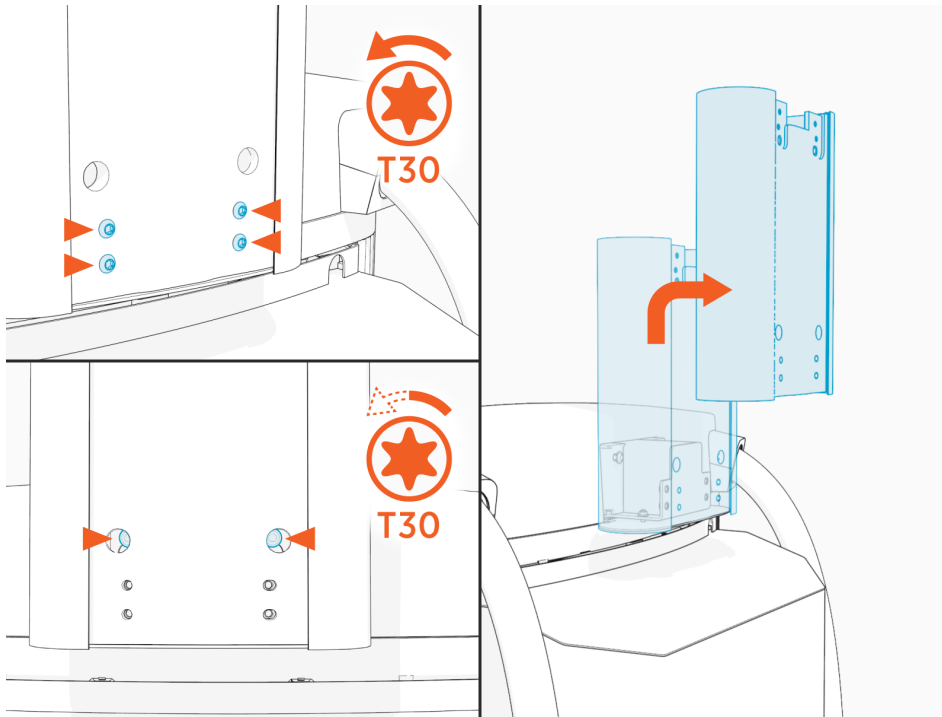

## Install the New CMK

**REVERSE THE ABOVE STEPS TO REPLACE THE MAST, SWINGARM ASSEMBLY, AND THE VINYL PANELS.**

## Power On the Station

Once all parts are installed, power on the Express 280. The Express 280 runs a self test to verify that it can operate properly.



**DANGER:** RISK OF SHOCK. If a fault exists, turn the power off at the service panel to BOTH product paired charging stations during work and keep it off until all panels are reinstalled. Internal components can present a shock hazard. FAILURE TO FOLLOW THESE INSTRUCTIONS CAN RESULT IN SERIOUS INJURY OR LOSS OF LIFE.

# Replace the Fan Tray Assembly 5

To replace the fan tray assembly, complete the following steps:

## Bring These Tools and Materials



T25 Security screwdriver



Stepladder

## Power Off the Station

Power off at the breaker panel and lock out/tag out before continuing work.

### **DANGER:** RISK OF SHOCK



- Before any procedure, disconnect the power. If station is paired, disconnect the power to both paired charging stations.
- Follow local code and site lockout/tagout procedure to de-energize the station.
- Wait for energy to dissipate (approximately five minutes).
- Keep power off until all covers and panels are reinstalled and the work is complete.

FAILURE TO FOLLOW THESE INSTRUCTIONS CAN RESULT IN SERIOUS INJURY, LOSS OF LIFE, OR PROPERTY DAMAGE.

## Remove the Fan Tray Assembly

1. Use a T25 security screwdriver to loosen the two screws that secure the top of the upper rear panel to the enclosure frame.



**NOTE:** When replacing this panel, torque the screws to **4.5 Nm (40 in-lb)**.

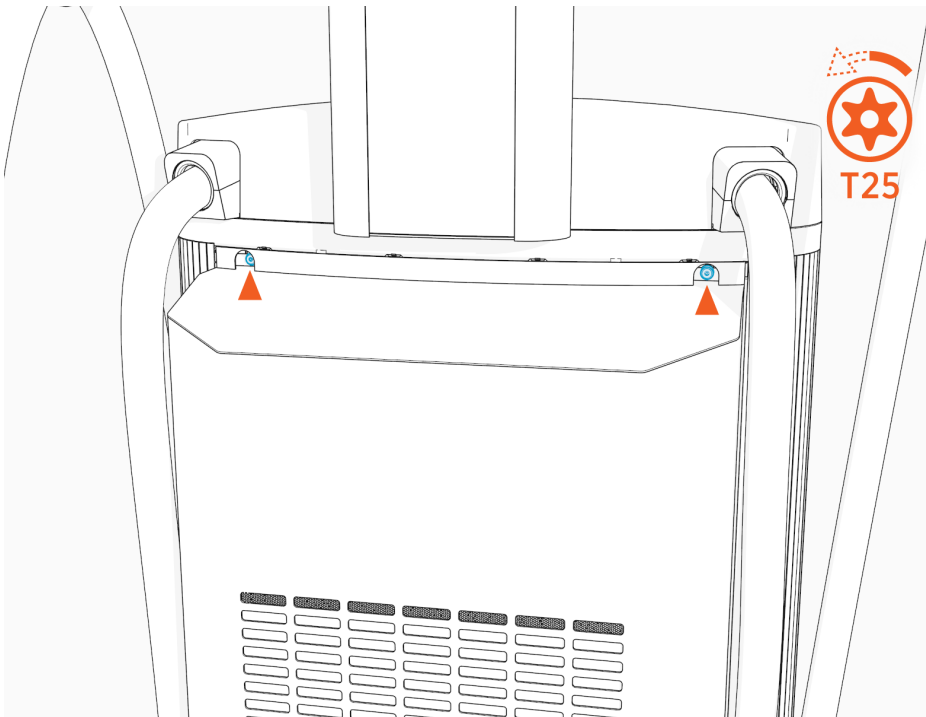

2. Use two hands to pull the upper rear panel away from the station. Then lift it up and take it off the keyholes to remove it.

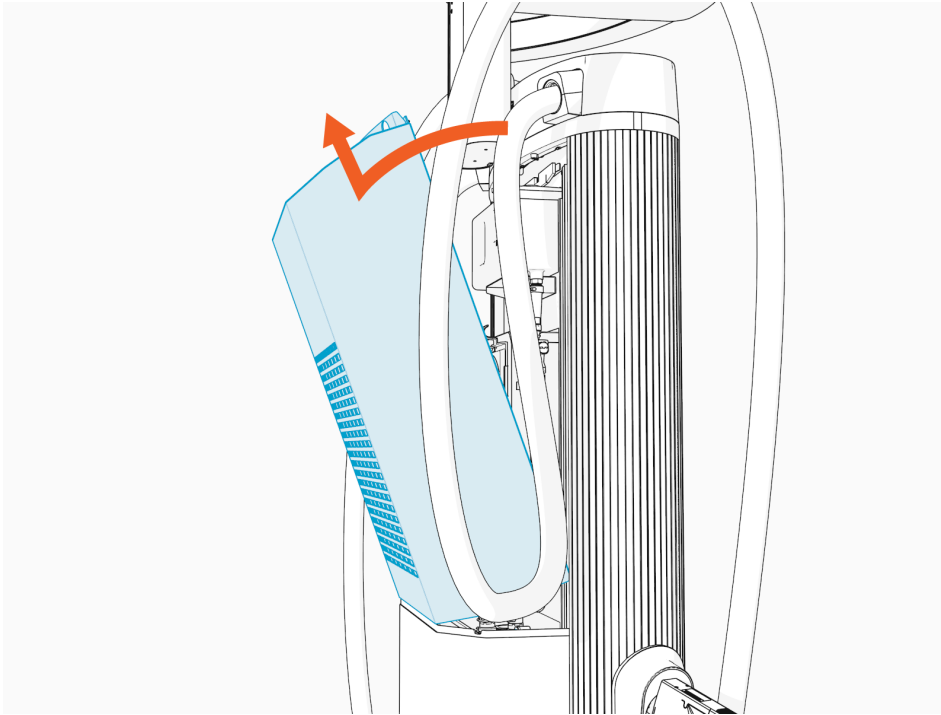

3. The system has two fan trays (left and right). On the fan tray to be replaced, pull the tab (a) forward to disengage it.

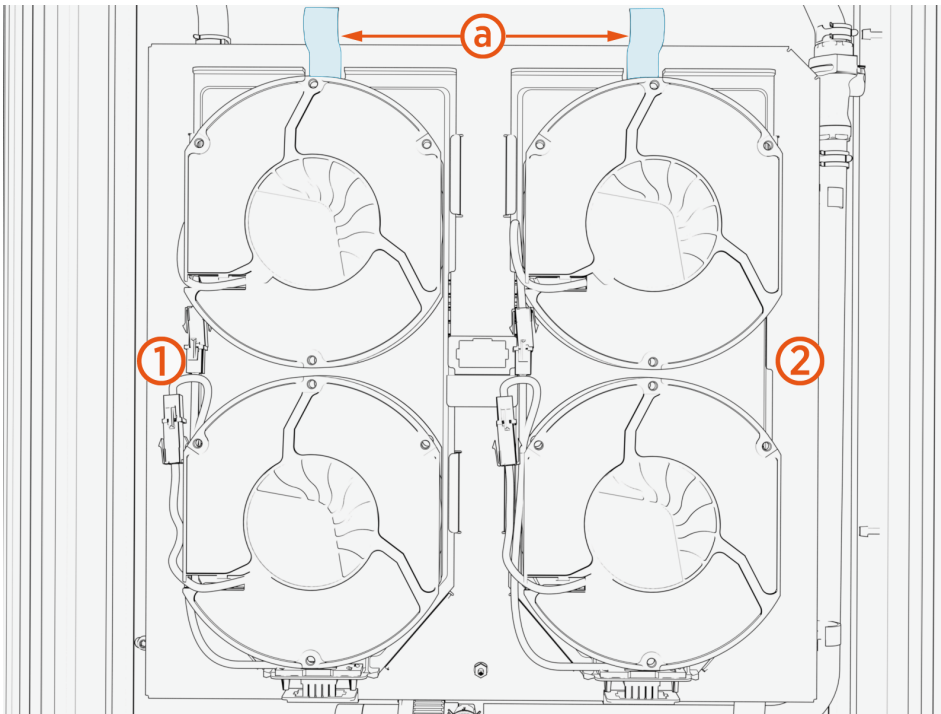

4. With both hands, slide the tray upward until the mounting tabs **(b)** on the fan tray assembly are positioned above their corresponding slots.



**NOTE:** Check that the power connector at the base of the fan assembly easily disengages as the fan tray is lifted.

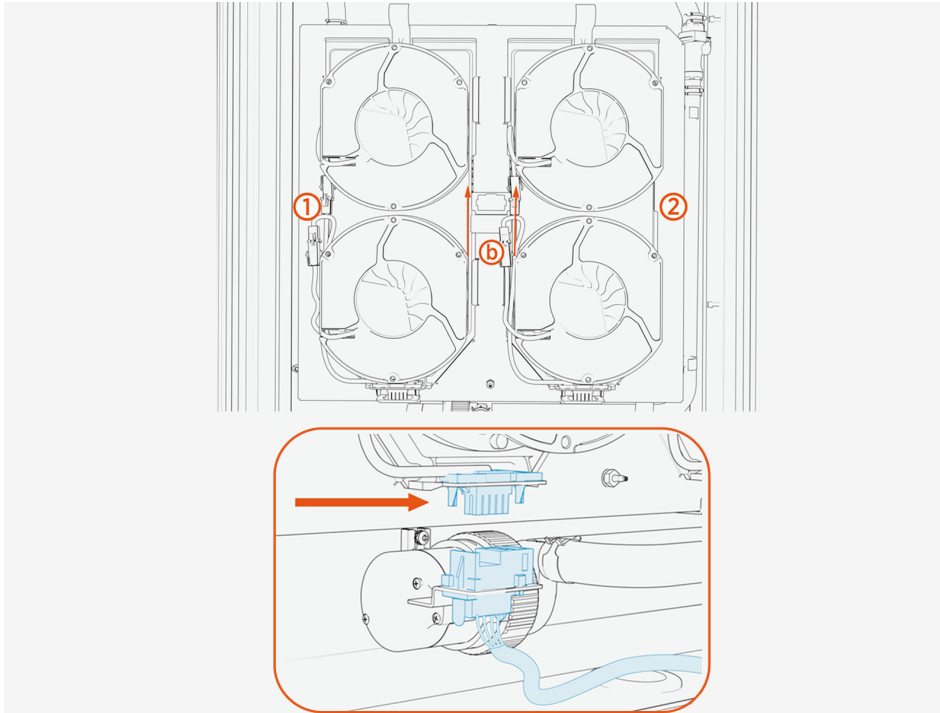

5. Pull the fan tray assembly toward you to remove it.

## Install the New Fan Tray Assembly

REVERSE THE ABOVE STEPS TO REPLACE THE FAN TRAY ASSEMBLY AND THE UPPER REAR PANEL.

## Power On the Station

Once all parts are installed, power on the Express 280. The Express 280 runs a self test to verify that it can operate properly.



**DANGER:** RISK OF SHOCK. If a fault exists, turn the power off at the service panel to BOTH product paired charging stations during work and keep it off until all panels are reinstalled. Internal components can present a shock hazard. FAILURE TO FOLLOW THESE INSTRUCTIONS CAN RESULT IN SERIOUS INJURY OR LOSS OF LIFE.

# Replace a Charging Cable 6

To replace a charging cable, complete the following steps.

## Bring These Tools and Materials



Torx screwdriver (T25, T20)



T25 Security screwdriver



10 mm socket hex wrench



Headlamp

## Power Off the Station

Power off at the breaker panel and lock out/tag out before continuing work.

### **DANGER:** RISK OF SHOCK



- Before any procedure, disconnect the power. If station is paired, disconnect the power to both paired charging stations.
- Follow local code and site lockout/tagout procedure to de-energize the station.
- Wait for energy to dissipate (approximately five minutes).
- Keep power off until all covers and panels are reinstalled and the work is complete.

FAILURE TO FOLLOW THESE INSTRUCTIONS CAN RESULT IN SERIOUS INJURY, LOSS OF LIFE, OR PROPERTY DAMAGE.

# Remove the Area Light Bar

To remove the area light bar, complete the following steps:

1. Use a T25 Security screwdriver to loosen the two captive screws on the bottom edge of the area light bar.



**NOTE:** When reinstalling the area light bar, route the cable through the notch in the center of the area light bar. Ensure the cable does not get caught between the area light bar and the secondary display controller. **Torque to 2.8 Nm (25 in-lb).**

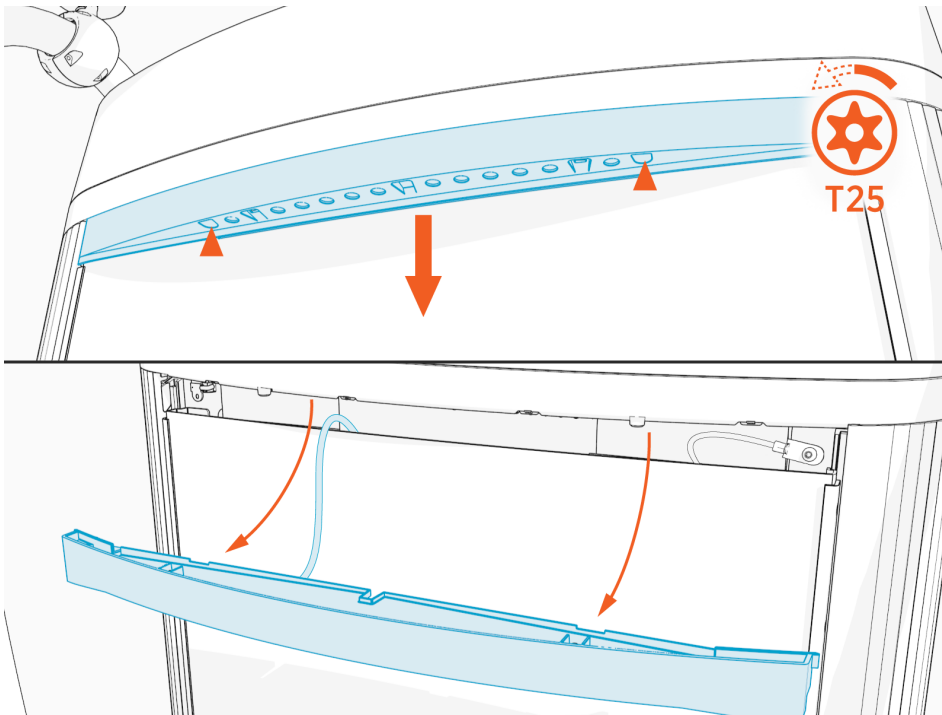



2. While holding the area light bar near the opening at the top of the Express 280, disconnect the 4-pin power cable from the area light bar.

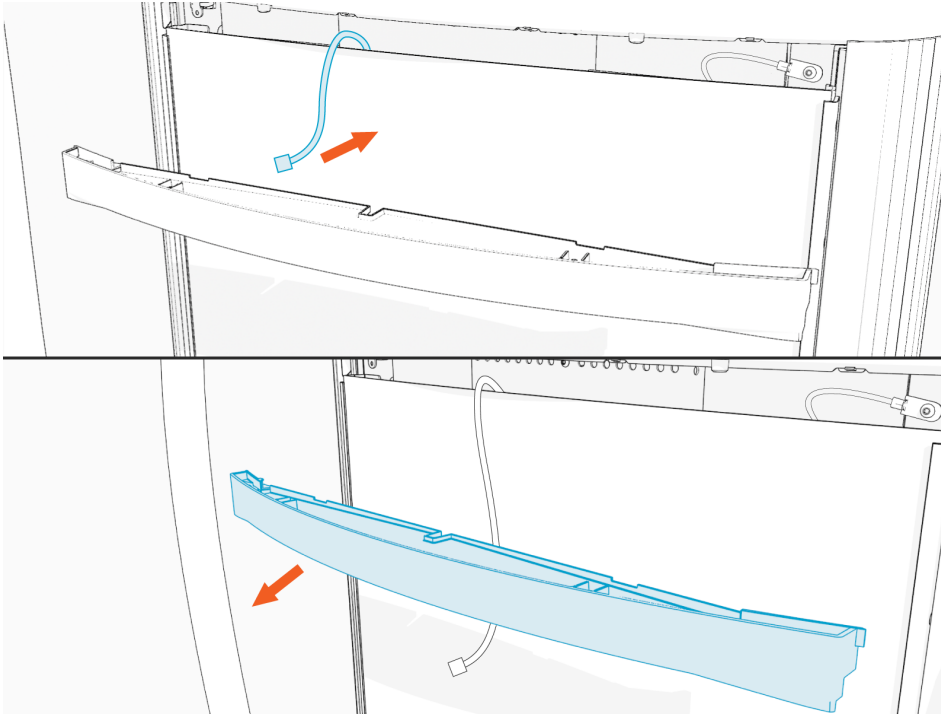

3. Set the area light bar gently on a padded surface.

## Remove the Upper Panels and Top Cap

To remove the upper panels and top cap, complete the following steps:

1. Gently pull the middle section of the trim panel out until the tabs clear the side trim. Remove the trim panel.

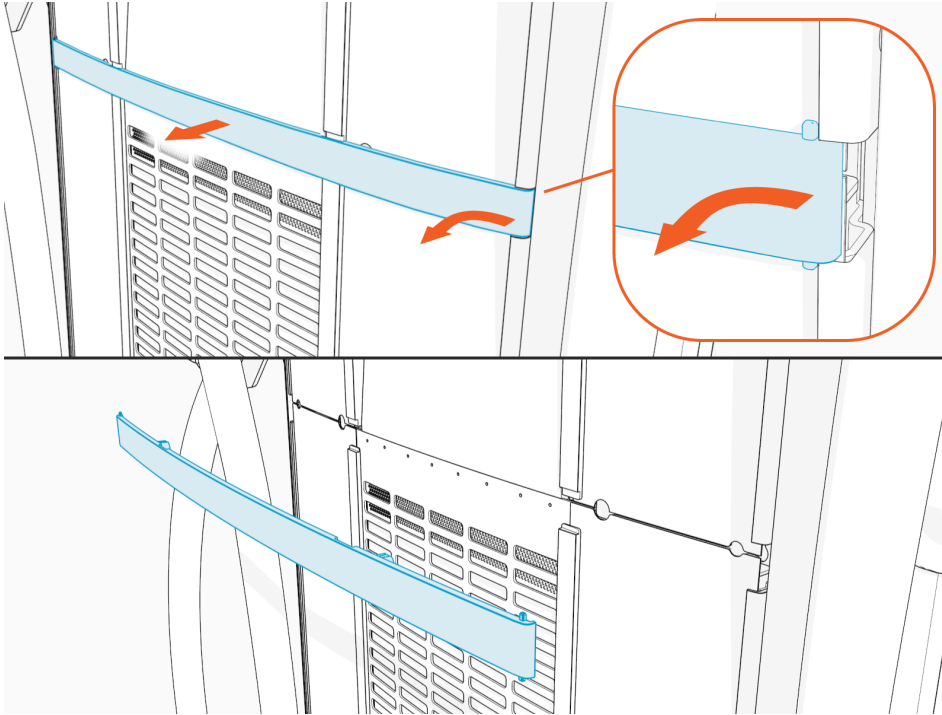

2. Use both hands to carefully pull the panel away from the station body and lift upward to remove it.

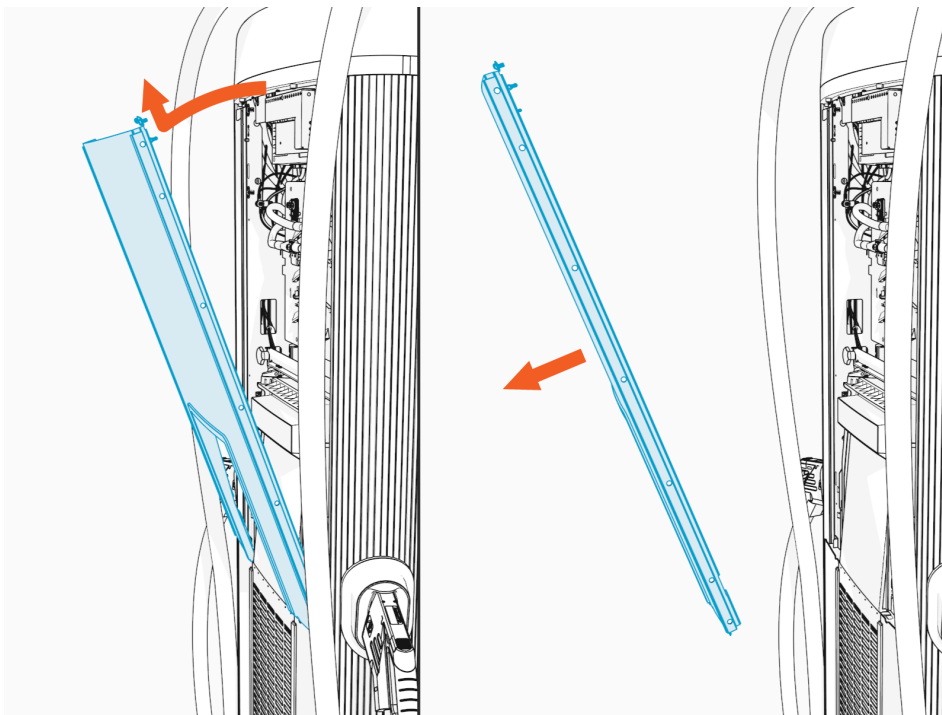

3. Place a protective cover, such as a lint-free cloth, over the touchscreen to prevent damage during service.

4. Use a T25 security screwdriver to loosen the two screws that secure the top of the upper rear panel to the enclosure frame.



**NOTE:** When replacing this panel, **torque to 4.5 Nm (40 in-lb)**.

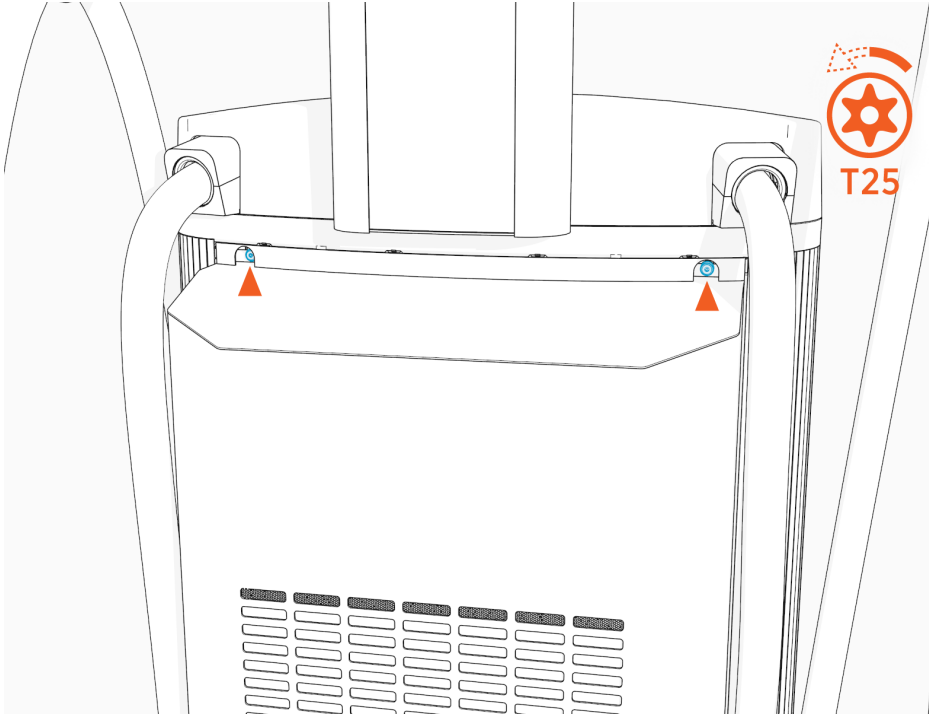

5. Use two hands to pull the upper rear panel away from the station and lift up to remove it.

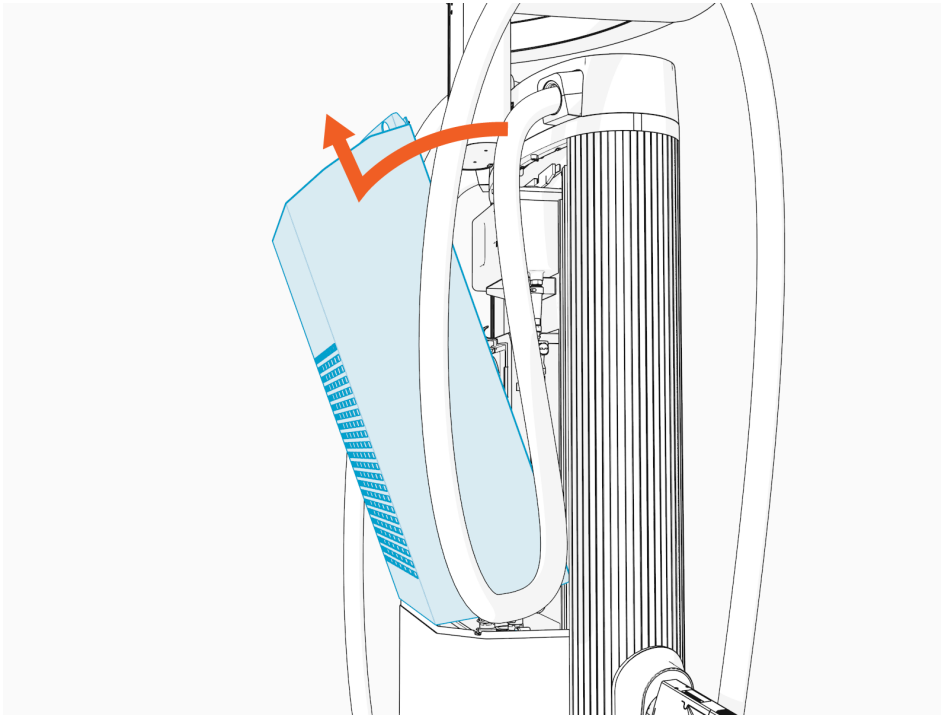

6. Use a T25 Torx screwdriver to loosen the four screws securing the top cap. Slide the latch to the right to release the tab.

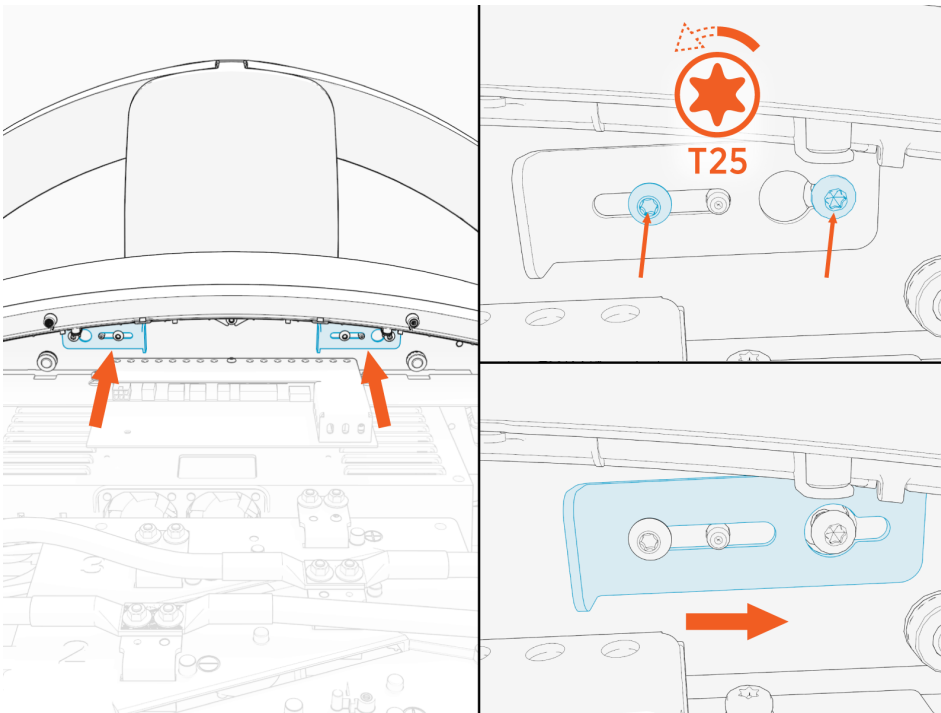

7. Lift the top cap upward to remove it.

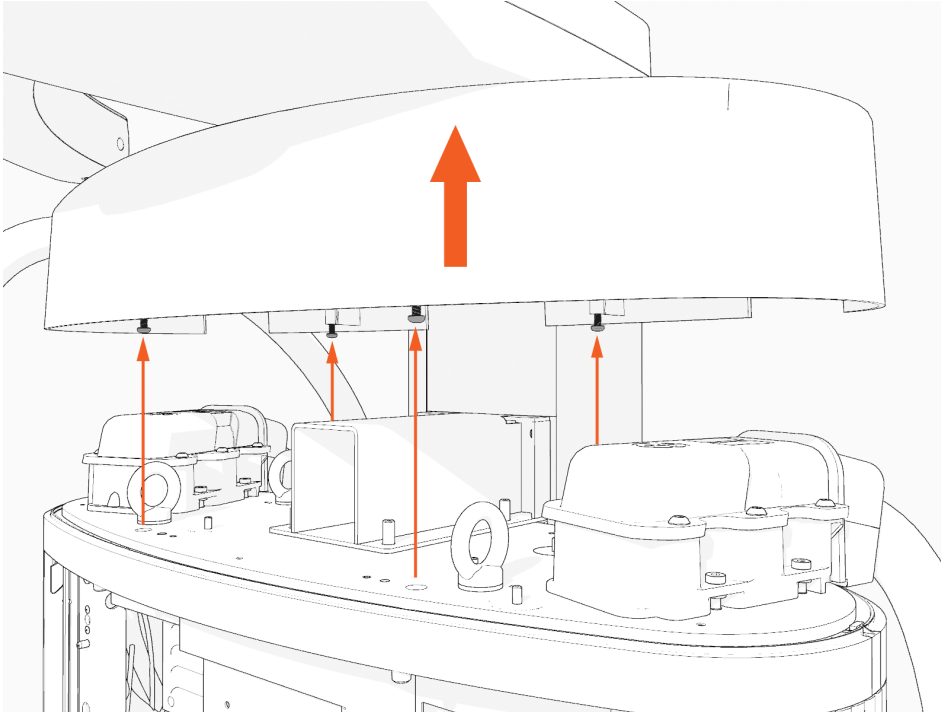

# Remove the Charging Cables

To remove the charging cables, complete the following steps:

## IMPORTANT:

If you are replacing the charging cable with a NACS cable, you must replace the cable on the left side of the station (a).



If the station has a CCS charging cable on the left side and a CHAdeMO charging cable on the right side and you are replacing the CHAdeMO cable with a NACS cable, follow these steps:

1. Remove both the CCS and CHAdeMO cables.
2. Install the CCS charging cable on the right side of the station.
3. Install the new NACS charging cable on the left side.

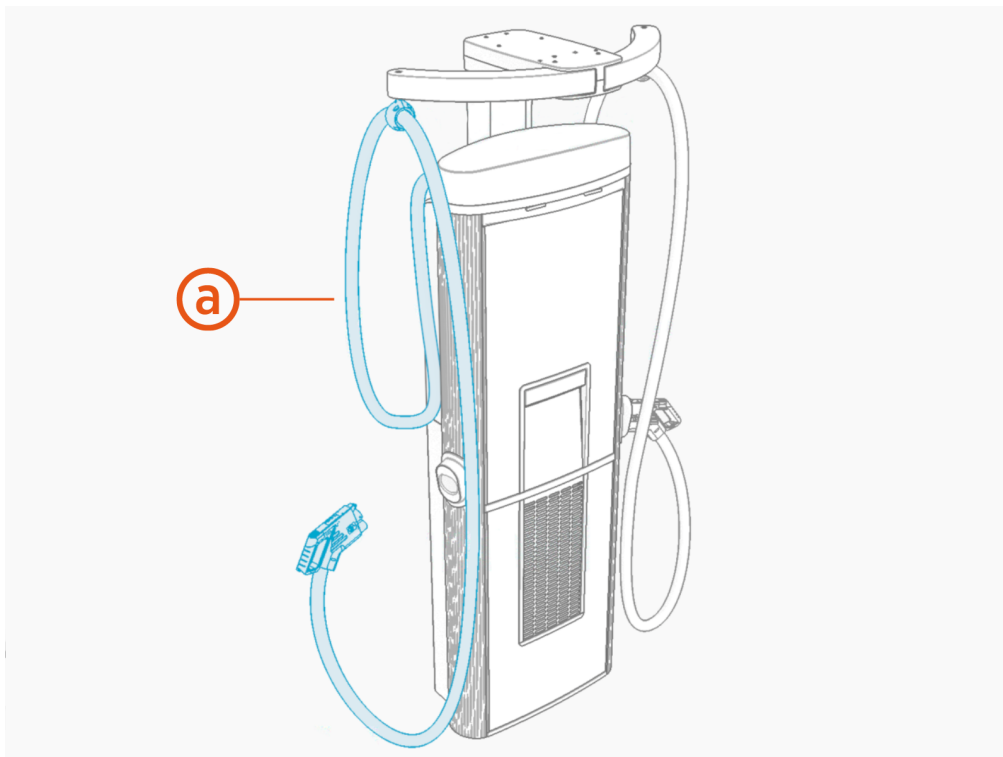

1. Remove the charging cables and set them down gently on a padded surface.

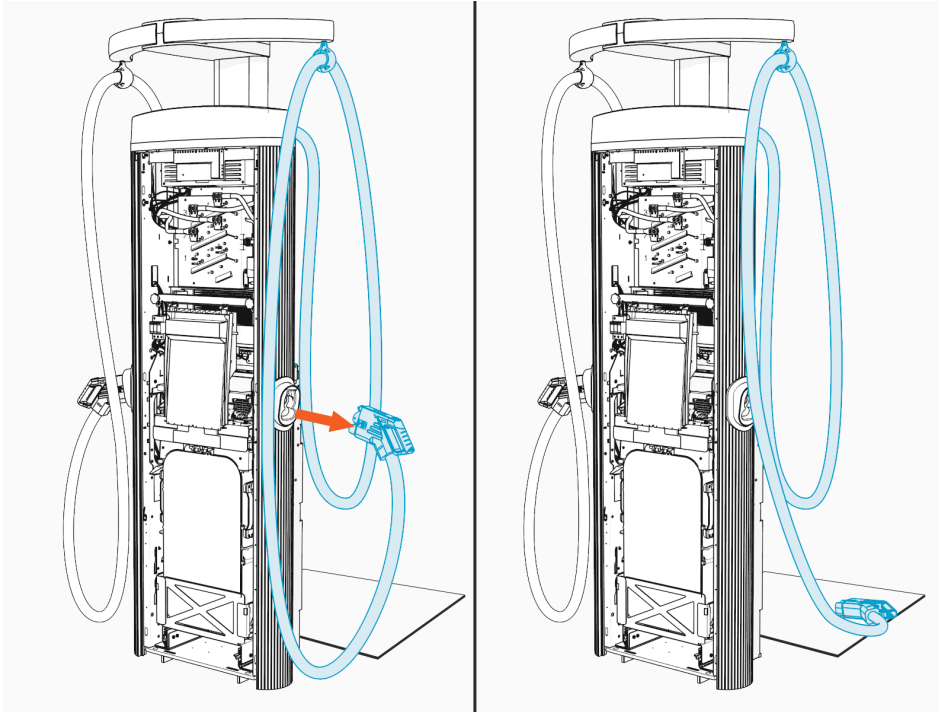

2. Use a T20 Torx screwdriver to loosen the set screw on the tether ball. Use a flat blade screwdriver to depress the spring while pushing the tether ball up to remove the tether ball.



**NOTE:** When replacing the tether ball and cable, align the spring in the ball clamp with the flat notch on the anchor pin. When aligned, push the ball clamp onto the anchor pin. **Torque the set screw to 2.8 Nm (25 in-lb).**

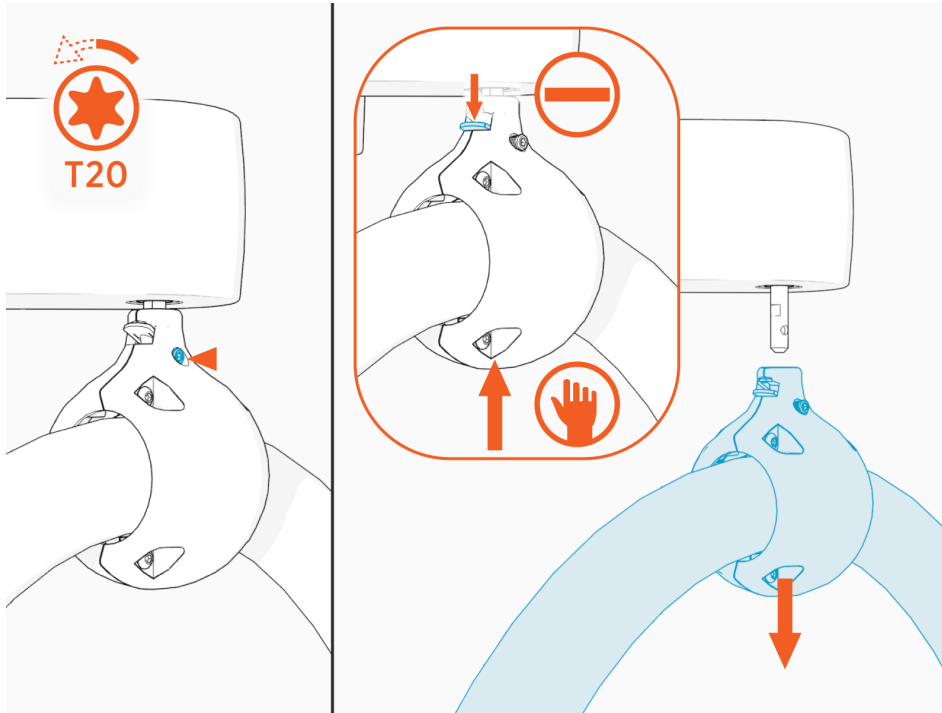



3. Set the charging cable aside gently.

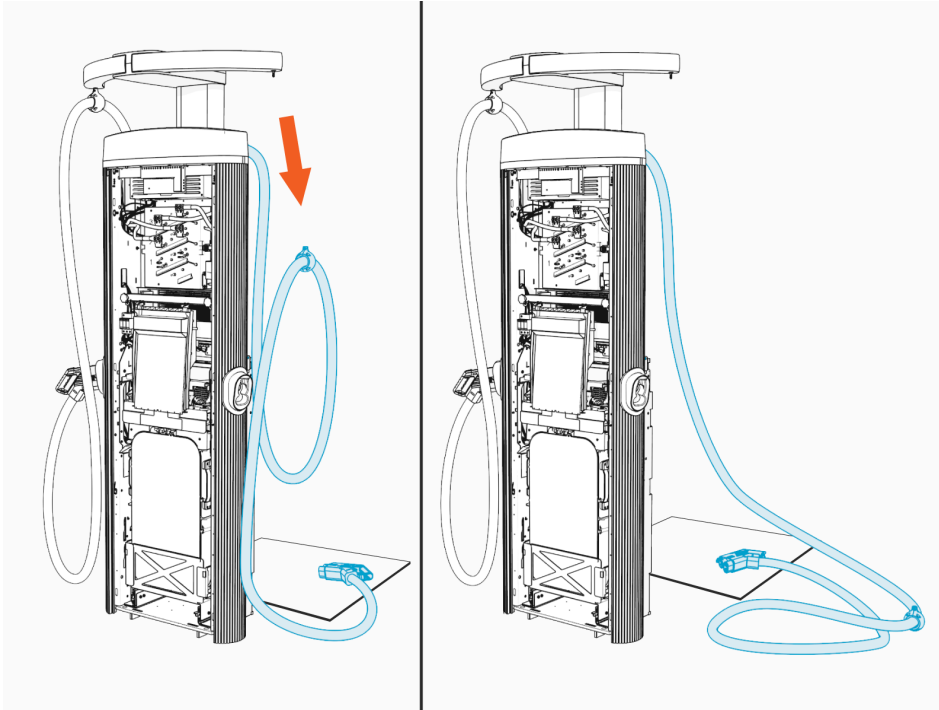

## Remove Data and DC Cables

To remove data and DC cables, complete the following steps:

1. Disconnect the data cable extension from the main data cable **(a)**.

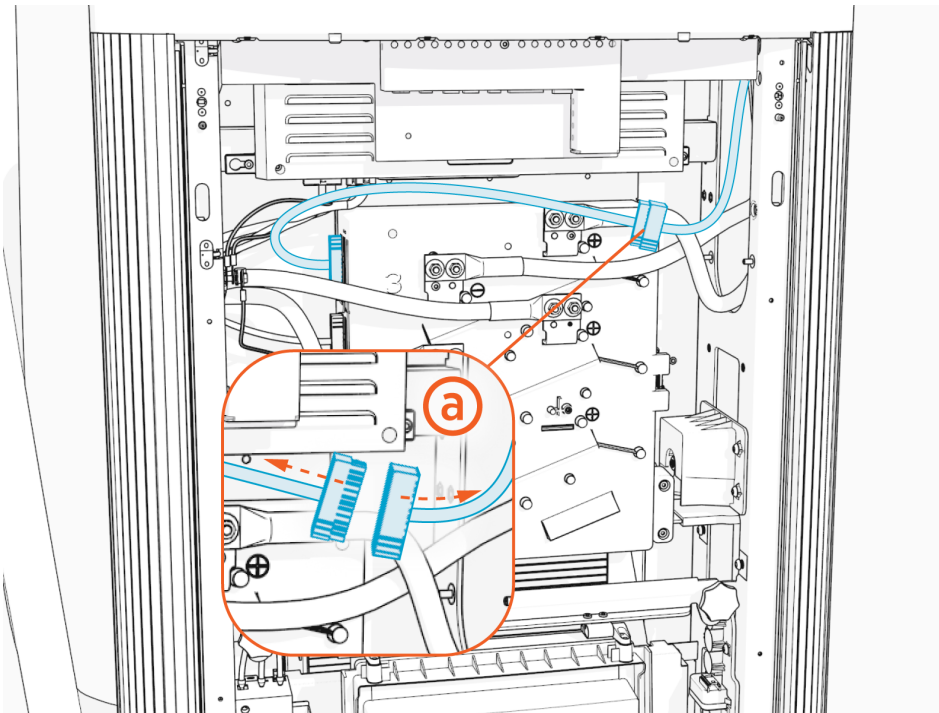

2. Use a 10 mm socket hex driver to disconnect the positive and negative conductors from the front tabs of the connector box.

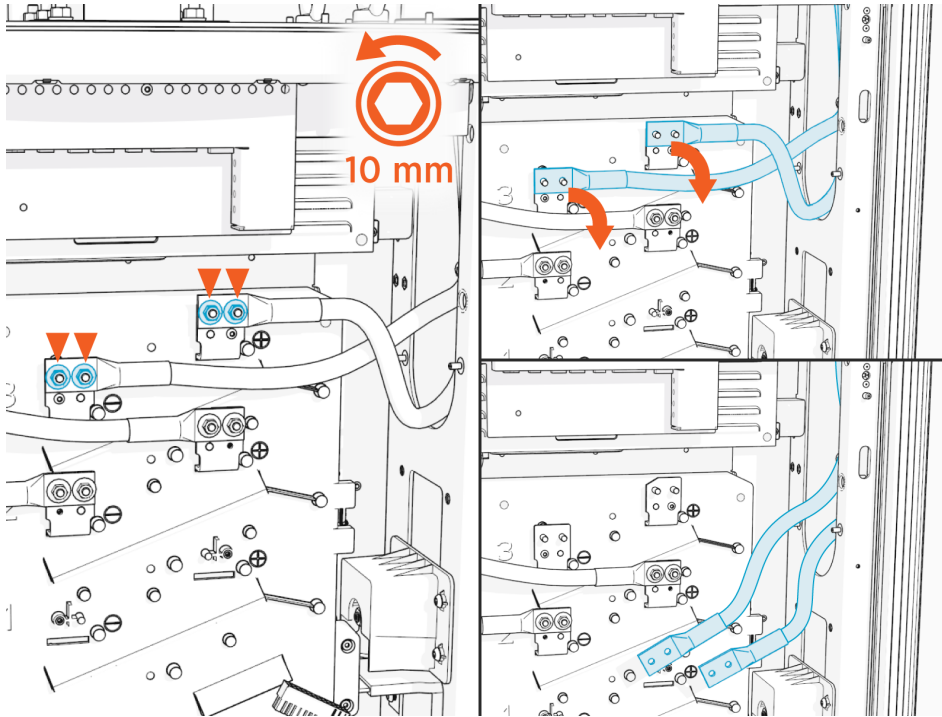

3. Use a T25 Torx screwdriver to loosen the four screws securing the charging cable housing.

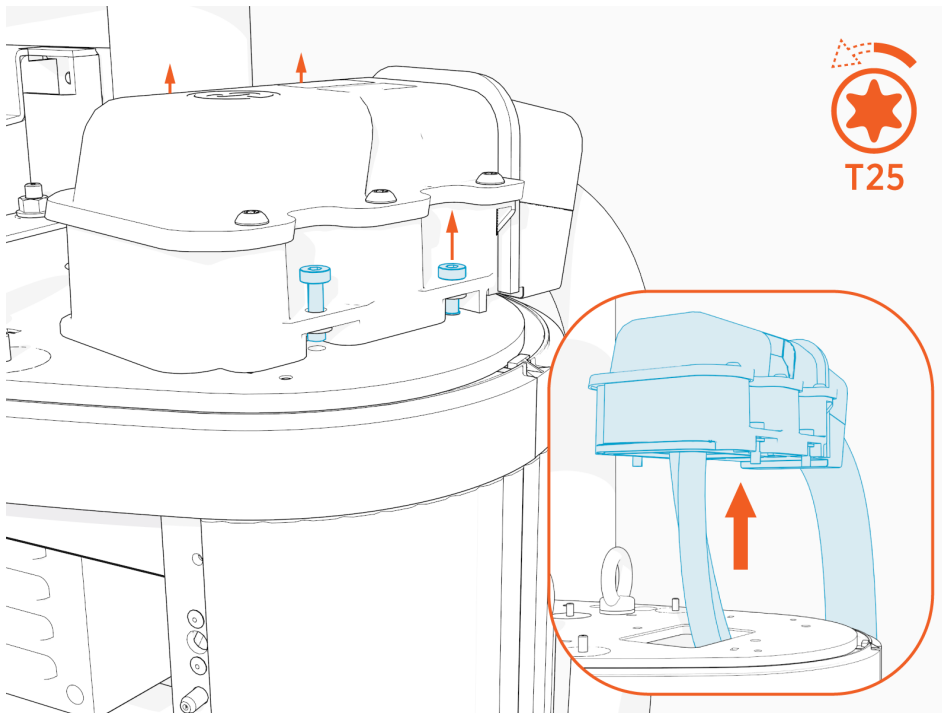

4. Remove the DC (a) and data (b) cables. Route the DC cables gently through the ferrite (c) stack.

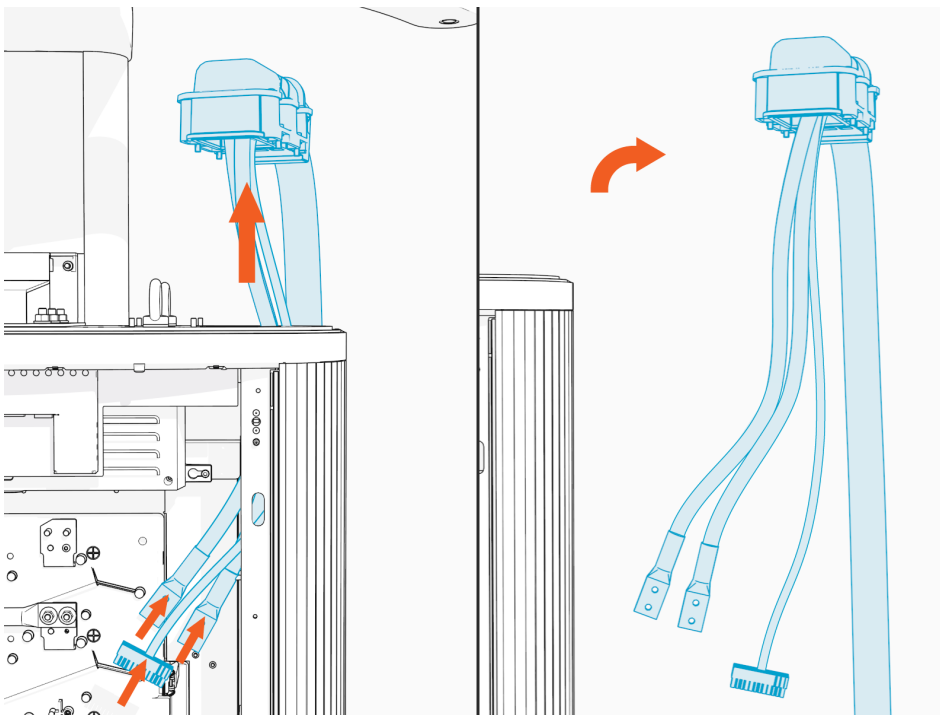
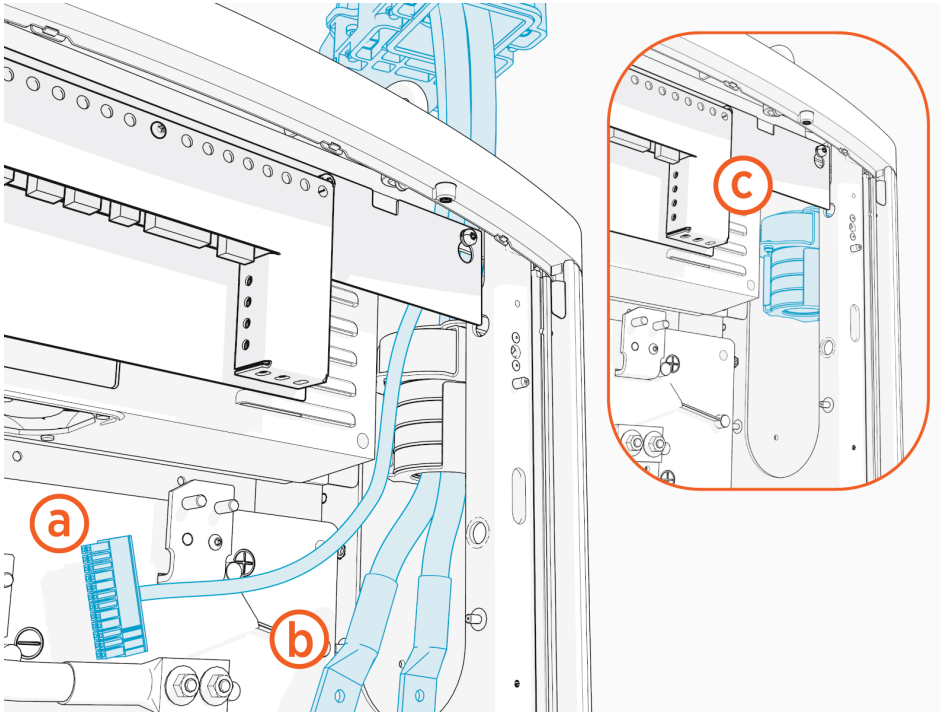

## Install the New Charging Cable

To install the new charging cable, complete the following steps:

- a. Guide the DC, ground, and data cables gently through the top of the station.

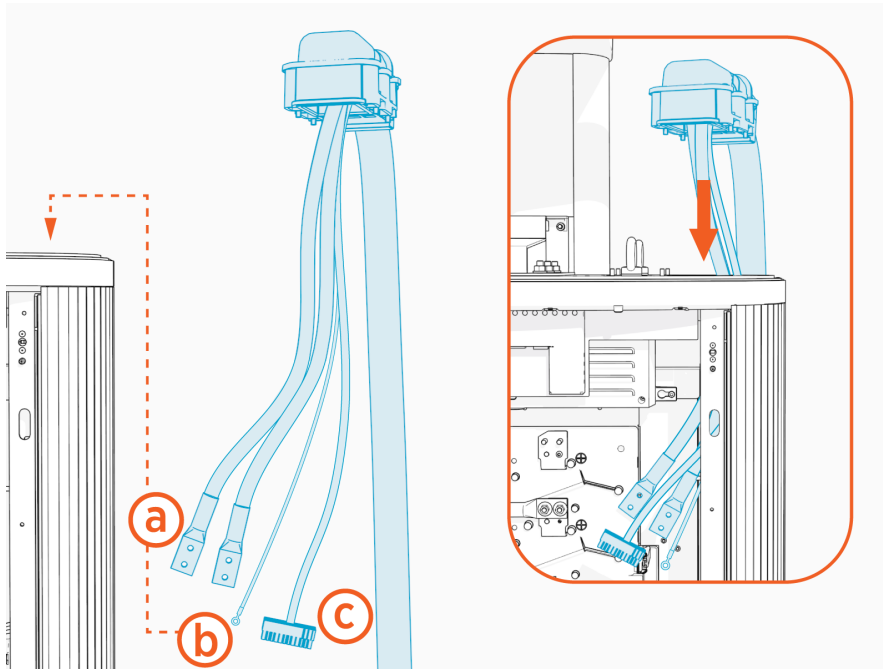

- (a) DC  
(b) Ground  
(c) Data

- b. Route the cables through the ferrite stack.

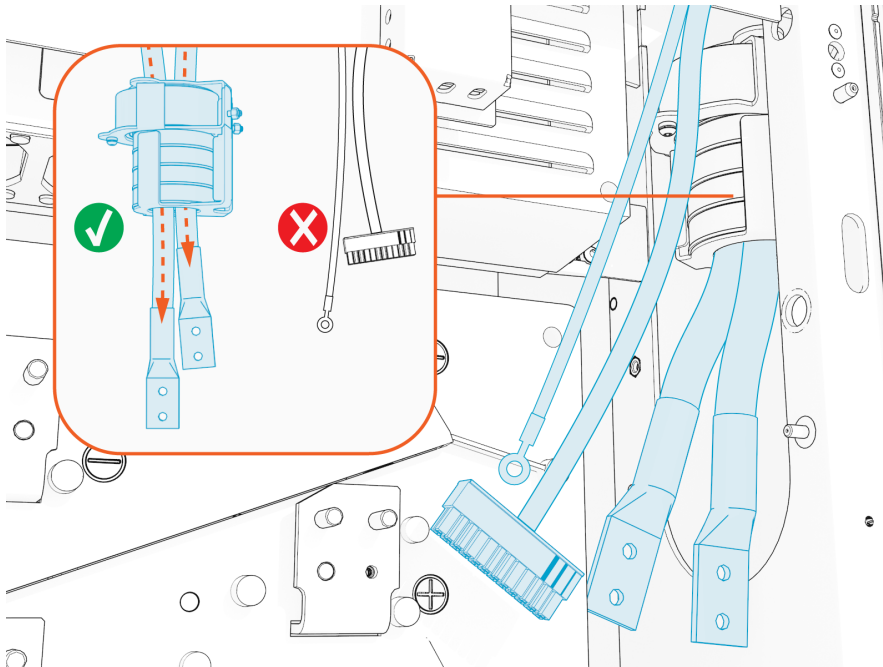

- c. Use a T25 Torx screwdriver to tighten the four screws securing the charging cable housing. Torque to **4.5 Nm (40 in-lb)**.

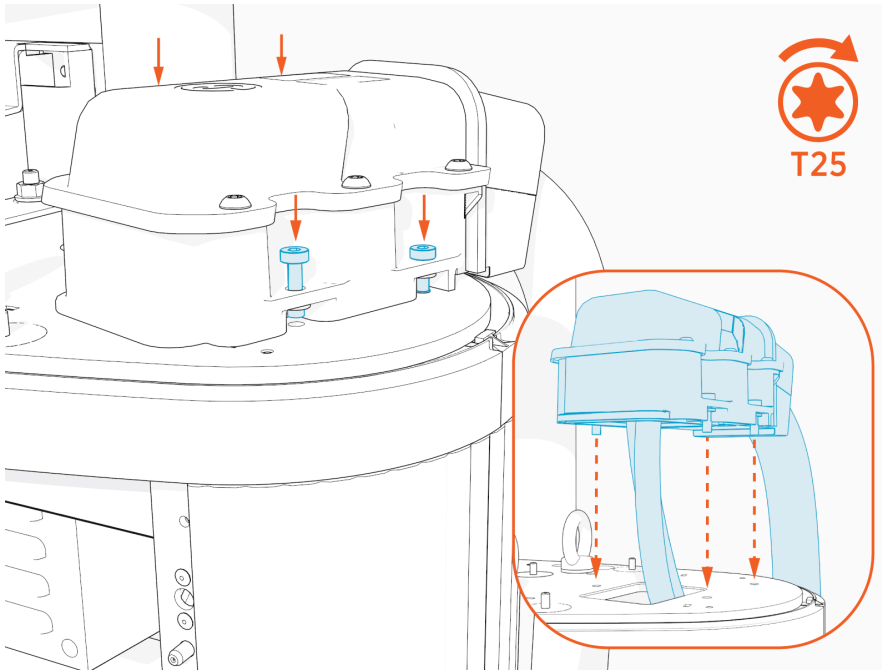

- d. Apply a thin coat of dielectric grease on each lug.

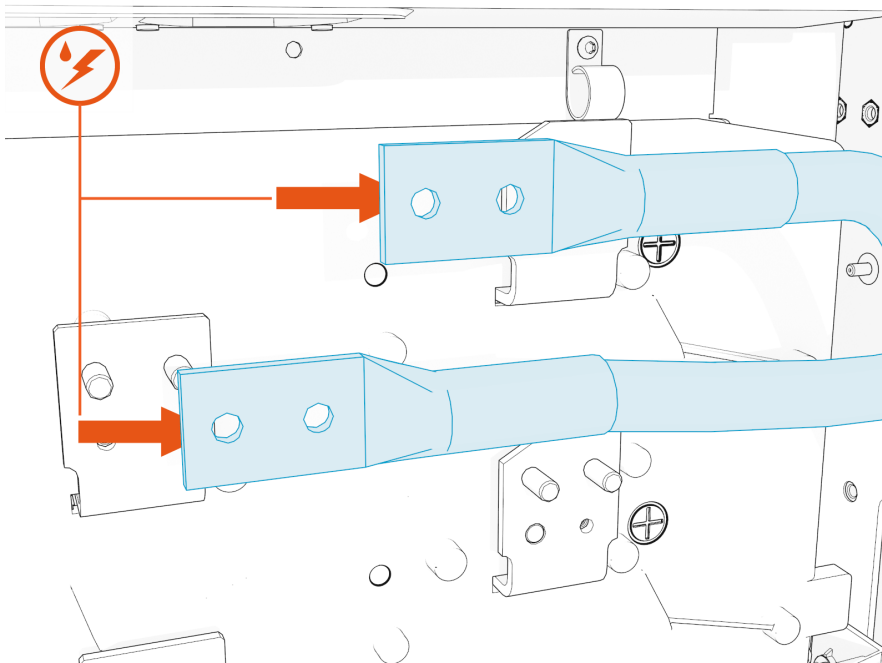

- e. When you are connecting a charging cable on the right side of the station, use a 10 mm socket hex driver to connect the positive and negative DC conductors from the front tabs of the connector box to the upper set of connectors.

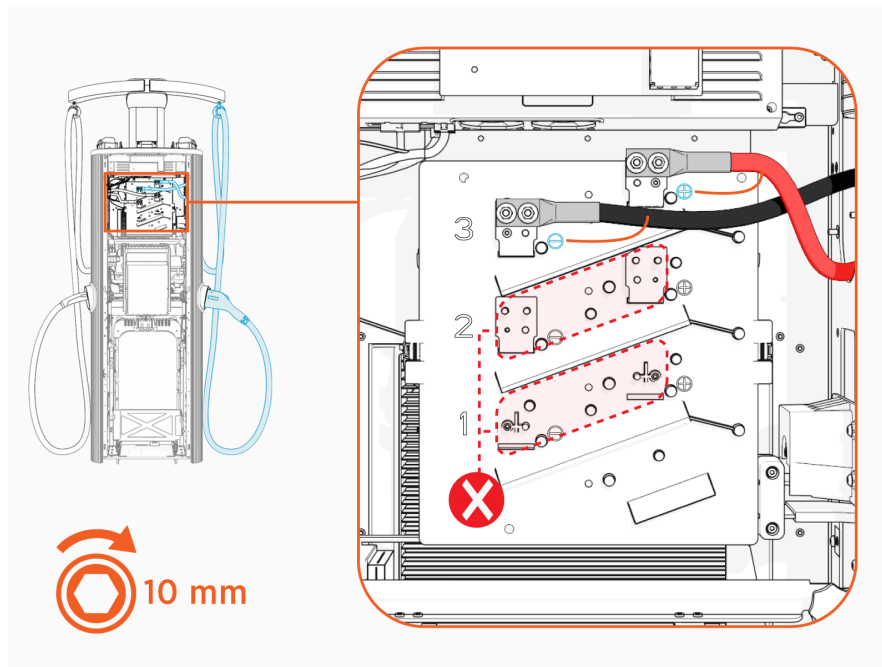

Use the middle set of DC connectors for charging cables on the left side of the station.

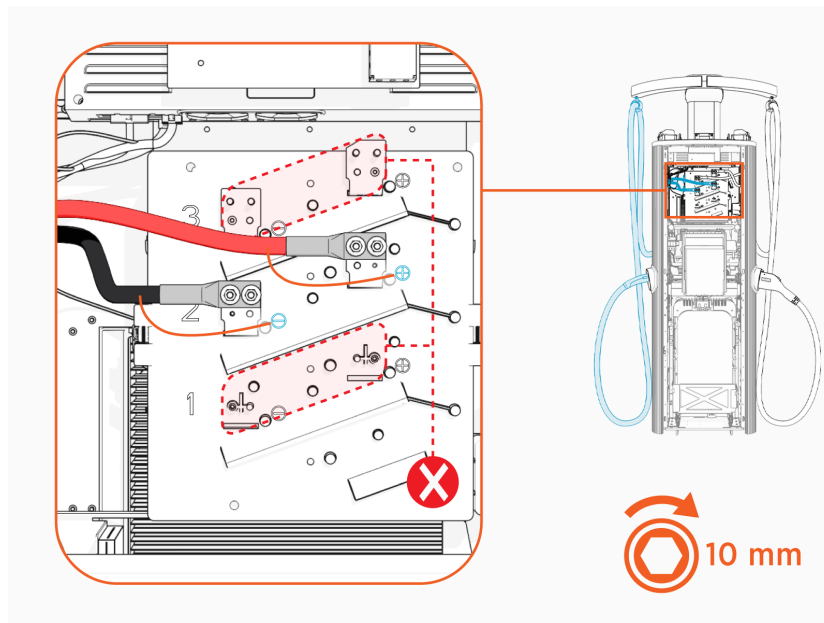

**IMPORTANT:**

Ensure that the cables have the proper polarity and they are connected to the correct set of terminals in the correct row.

- f. If the station is being configured with two CCS charging cables, or if a single CCS cable is installed, connect a data cable extension to the main data cable.

Guide the data cable extension behind the contactor box to connect to the CCS cable and the upper data connector.

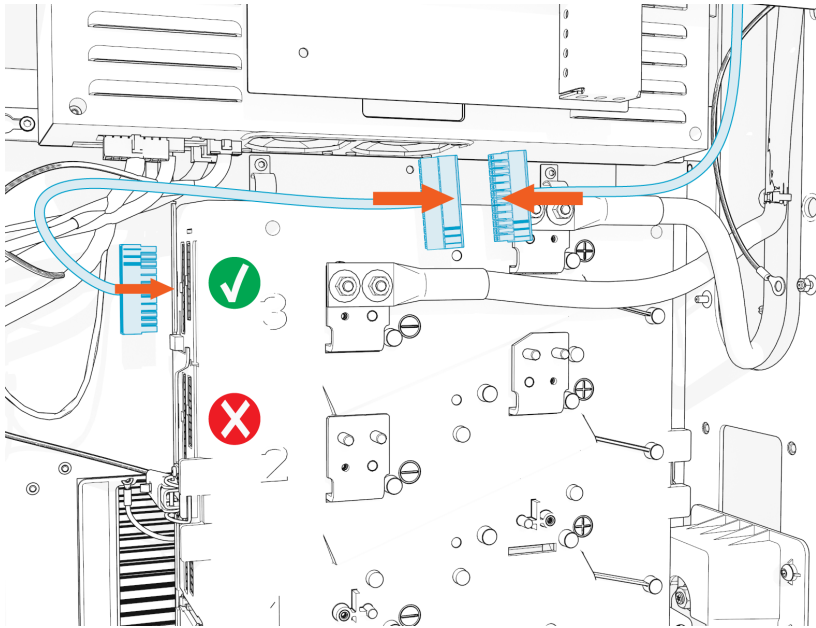

If the single CCS is being installed on the left side when you are standing in front of the station, you do not need the data cable extension. Connect the data cable to the lower data connector.

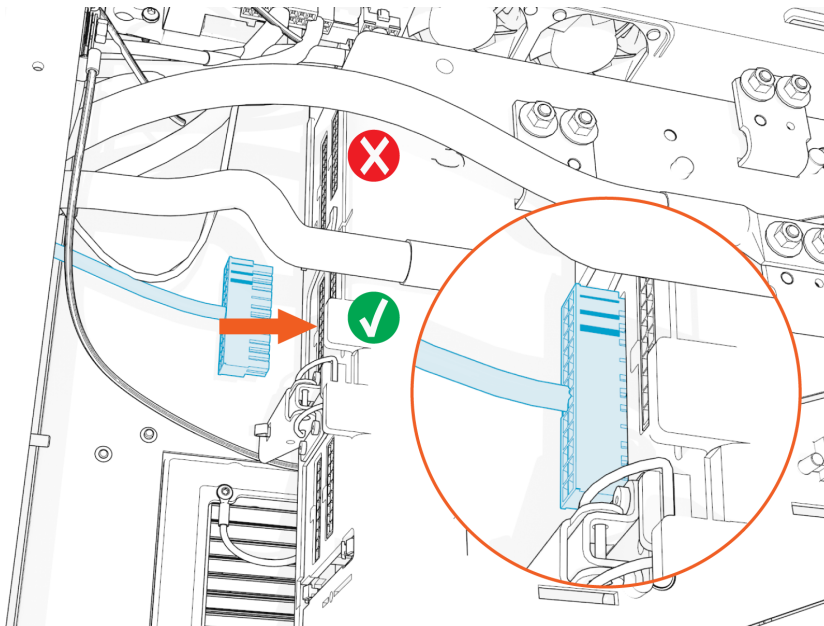

**REVERSE THE ABOVE STEPS TO REINSTALL THE TETHER BALL, TOP CAP, UPPER PANELS AND AREA LIGHT BAR.**

## Power On the Station



**DANGER:** Ensure all panels are installed before powering station on.

Once all parts are installed, power on the Express 280. The Express 280 runs a self test to verify that it can operate properly.



**DANGER:** RISK OF SHOCK. If a fault exists, turn the power off at the service panel to BOTH product paired charging stations during work and keep it off until all panels are reinstalled. Internal components can present a shock hazard. FAILURE TO FOLLOW THESE INSTRUCTIONS CAN RESULT IN SERIOUS INJURY OR LOSS OF LIFE.



## Limited Warranty Information and Disclaimer

The Limited Warranty you received with your charging station is subject to certain exceptions and exclusions. For example, your use of, installation of, or modification to, the ChargePoint® charging station in a manner in which the ChargePoint® charging station is not intended to be used or modified will void the limited warranty. You should review your limited warranty and become familiar with the terms thereof. Other than any such limited warranty, the ChargePoint products are provided "AS IS," and ChargePoint, Inc. and its distributors expressly disclaim all implied warranties, including any warranty of design, merchantability, fitness for a particular purposes and non-infringement, to the maximum extent permitted by law.

## Limitation of Liability

CHARGEPOINT IS NOT LIABLE FOR ANY DIRECT, INDIRECT, INCIDENTAL, SPECIAL, PUNITIVE OR CONSEQUENTIAL DAMAGES, INCLUDING WITHOUT LIMITATION LOST PROFITS, LOST BUSINESS, LOST DATA, LOSS OF USE, OR COST OF COVER INCURRED BY YOU ARISING OUT OF OR RELATED TO YOUR PURCHASE OR USE OF, OR INABILITY TO USE, THE CHARGING STATION, UNDER ANY THEORY OF LIABILITY, WHETHER IN AN ACTION IN CONTRACT, STRICT LIABILITY, TORT (INCLUDING NEGLIGENCE) OR OTHER LEGAL OR EQUITABLE THEORY, EVEN IF CHARGEPOINT KNEW OR SHOULD HAVE KNOWN OF THE POSSIBILITY OF SUCH DAMAGES. IN ANY EVENT, THE CUMULATIVE LIABILITY OF CHARGEPOINT FOR ALL CLAIMS WHATSOEVER RELATED TO THE CHARGING STATION WILL NOT EXCEED THE PRICE YOU PAID FOR THE CHARGING STATION. THE LIMITATIONS SET FORTH HEREIN ARE INTENDED TO LIMIT THE LIABILITY OF CHARGEPOINT AND SHALL APPLY NOTWITHSTANDING ANY FAILURE OF ESSENTIAL PURPOSE OF ANY LIMITED REMEDY.